

NEE Components Pvt. Ltd.

(A member of NYLEX GROUP)



DUCTILE IRON THREADED PIPE FITTINGS

 **DUCTILE IRON
GROOVED FITTINGS**



FORGED BRASS VALVES



DUCTILE IRON VALVES (UL & FM LISTED)



MCI GALVANIZED PIPE FITTINGS



GOST
Approved

CE
Approved

UL
LISTED

Contents

SECTION 1

DUCTILE IRON VALVES (UL & FM LISTED)



Pages
3
to
17

Pages
18
to
27



DUCTILE IRON THREADED PIPE FITTINGS

DUCTILE IRON GROOVED FITTINGS

SECTION 2

SECTION 3

MCI GALVANIZED PIPE FITTINGS



Pages
28
to
38

Pages
39
to
42

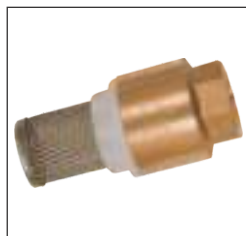

FORGED BRASS VALVES

SECTION 4



COMPANY PROFILE

UL / FM Listed Valves

We use this opportunity to introduce ourselves as a leading manufacturer & Supplier of G.I. / D.I. Pipe Fittings & Brass Valves for Water Supply, Plumbing, and Fire Fighting & Natural Gas Distribution for last 20 years.

We are pleased to introduce our UL/FM Approved Valves as shown in this Catalogue from 2" to 12".

1. UL/FM approved DI Gate Valves / Butterfly Valves / Check Valves.
2. D.I. Fittings for firefighting – UL/FM approved for Sprinkler System for Fire Fighting.
3. Brass valves – UL Listed, UL/FM approved for Fire Fighting & Plumbing System.
4. Malleable Iron Pipe Fittings (ISI Marked) for Plumbing System.
5. UL/FM Approved Grooved Fittings.

We wish to get our products approved for your upcoming projects.

Our Fittings & valves have been recommended by so many reputed consultants and have been used in the following projects:-

- Indira Gandhi International Airport Project, Delhi.
- Raja Bhoj Airport, Bhopal
- Pullman Airport Hotel, New Delhi
- Sheraton Hotel, Chandigarh
- EROS Group's Five Star Hotels coming up in NCR Region
 - o Holiday inn
 - o Mayur Vihar
- Nokia India Pvt. Ltd., Sriperumpudur (Tamil Nadu)
- Tata Housing
- Toshiba Chennai
- RBS -Royal Bank of Scotland – Gurgaon/ Chennai
- Lotus Panache, Noida, by 3Cs
- Star Court, Noida
- Rajeev Gandhi International Airport, Hyderabad, A.P.
- Ranchi Airport, Jharkhand.
- Marriot Hotel, Chandigarh
- ITC's Today Hotel Project in Bengaluru and in Delhi
- Westin Hotel, Gurgaon etc
- Wipro group, Gurgaon
- TRIL – Chennai
- Indian Express Towers, Mumbai (thru Firepro)
- Fortis Hospital, Gurgaon
- Lotus Boulevard, Noida by 3Cs
- BMW CAR Plant, Chennai

We have certification of Bureau of Indian Standards (BIS / ISI). To further certify our quality, the process systems as Jainsons Industries are ISO-9001: 2008 approved by UL-MSS India.

We have recently launched UL & FM Approved Ductile Iron Valves for Fire Fighting & Industrial Application.

To add on to our credibility, we are also on the approved vendor list of DMRC, i.e. Delhi Metro Rail Corporation, DGS&D, CIDCO Maharashtra and Bhilai Steel Plant, Bhilai.

We have supplied Malleable Cast Iron Galvanized Pipe Fittings for Fire Fighting Systems to following sub contractors of DMRC:-

- Larsen & Toubro Ltd. (Engineering, Construction & Contracts Division), New Delhi
- Kumagai Skanska HCC Itochu (KSHI) Group (Joint Venture)
- Schwing Setter India Pvt. Ltd., Sriperunpudur (Tamilnadu)

We always take care of on time delivery & quality workmanship to satisfy customer needs.

Please favor us your valuable enquiry for any of our products for quick reply.



RANGE OF PRODUCTS



D.I. NRS Resilient Gate Valve



D.I. OS & Y Resilient Gate Valve



Grooved Non-Rising Stem Gate Valve



D.I. Swing Check Valve Rubber Seal



D.I. Wafer Butterfly Check Valve

 **GOST Approved**



D.I. Wafer Butterfly Valve

(Z45X) PN10/PN16/PN25

BS Standard Non-Rising Stem Resilient Wedge Gate Valves Type A T key (Z45X) PN10/PN16/PN25

Statement:

The gate valve can seal flow well with its soft wedge. Where the working temperature is $\leq 80^{\circ}\text{C}$. They are widely used in architectonics, edibles, medicine, chemical energy, supplying and draining water industry, etc. It adjusts the water in piping line and in equipments.

MATERIAL SPECIFICATIONS

Standard:
: BS 5163

Connection Ends:
: BS EN 1092-2
Flange: BS EN 1092-2

Drive Style:
Lever handle
Electric drive
Pneumatic drive

Test Pressure:
PN10 Shell:1.5MPa Seal:1.1MPa
PN16 Shell:2.4MPa Seal:1.76MPa
PN25 Shell:3.75MPa Seal:2.75MPa

Applicable Temperature:
0°C-80°C

Surface:
150-500um, AWWA C550
Coating: Akzo Nobel Fusion Bonded Epoxy Coating with thickness 150-500um, Complies with ANSI/AWWA C550.

Applications:
Potable water, water supply and drainage, sewage disposal, irrigation air condition and fire protection pipe system etc.

Note: The first material is basic configuration. If you have different requirement on accessories, please remark it on inquiry.
Optional accessories: stem nut, electric drive, pneumatic drive, stem 2Cr13, stem 304, stem 316, brass thrust washer H62, brass thrust washer Hpb59-1, Indicator.

Part No.	Part	Specification
1	Valve Body	Ductile Iron QT450-10
2	Resilient Wedge Disc	Ductile Iron QT450-10/EPDM
3	Stem	Stainless Steel Cr13,304,316
4	Nut	Carbon Steel Zinc Plated
5	Bonnet	Ductile Iron QT450-10
6	O-Ring	NBR or EPDM
7	Gland Flange	Ductile Iron QT450-10
8	Handwheel	Ductile Iron QT450-10
9	Bolt	Carbon Steel Zinc Plated
10	Flat Washer	Carbon Steel Zinc Plated
11	Ring Wiper	NBR or EPDM
12	Bolt	Carbon Steel Zinc Plated
13	Flat Washer	Carbon Steel Zinc Plated
14	O-Ring	NBR or EPDM
15	Thrust Washer	Brass H62 or Hpb59-1
16	Bonnet Gasket	EPDM
17	Wedge Nut	Bronze ZQSn5-5-5
18	Indicator Board	Carbon Steel
19	Pointer	Cast Aluminium
20	Screw	Carbon Steel



Z45X
Flanged non-rising stem gate valve with wheel and indicator



Z45XC
Flanged non-rising stem gate valve with stem cap



Z35X
Mechanical joint non-rising stem gate valve with wheel



Z85X
Grooved non-rising stem gate valve with wheel



Features:

Akzo Nobel Fusion Bonded Epoxy Coating: Inside and Outside, can be used for potable water, food and pharmaceuticals industries with long life.

Material: Ductile Iron Body, Bonnet, Wedge and Handwheel, high strength and corrosion resisting. Valve seat cast with body at the same time, not necessary to machine.

Triple O-Ring stem seals make valves having axial self seals without the trouble of packing seal adjustment. The ring wiper can stop impurity going into shaft seal.

When valve is opened completely, It will have a smooth unobstructed waterway, without groove which will maintain sundries. The same O.D. will not affect fluid medium.

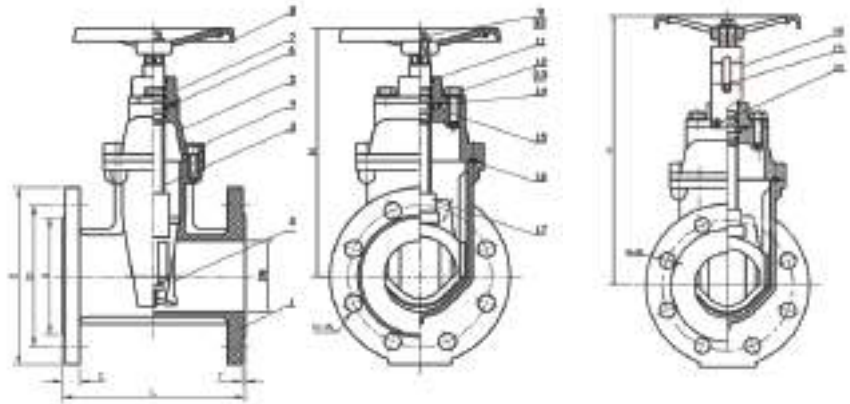

DIMENSIONS

DN		PN	Dimensions (mm)							
inch	mm		L	H	D	D1	d	C	T	N-φL
2"	50	10/16	178	218	165	125	99	19	3	4-φ19
		25	178	218	165	125	99	19	3	4-φ19
2.5"	65	10/16	190	230	185	145	118	19	3	4-φ19
		25	190	230	185	145	118	19	3	8-φ19
3"	80	10/16	203	281	200	160	132	19	3	8-φ19
		25	203	281	200	160	132	19	3	8-φ19
4"	100	10/16	229	316	220	180	156	19	3	8-φ19
		25	229	316	235	190	156	19	3	8-φ23
6"	150	10/16	267	420	285	240	211	19	3	8-φ23
		25	267	420	300	250	211	20	3	8-φ28
8"	200	10	292	490	340	295	266	20	3	8-φ23
		16	292	490	340	295	266	20	3	12-φ23
		25	292	490	360	310	274	22	3	12-φ28
10"	250	10	330	680	405	350	319	22	3	12-φ23
		16	330	680	405	355	319	22	3	12-φ28
		25	330	680	425	370	330	24.5	3	12-φ31
12"	300	10	356	740	460	400	370	24.5	4	12-φ23
		16	356	740	460	410	370	24.5	4	12-φ28
		25	356	740	485	430	389	27.5	4	16-φ31
14"	350	10	381	800	505	460	429	24.5	4	16-φ23
		16	381	800	520	470	429	26.5	4	16-φ28
		25	381	800	555	490	448	30	4	16-φ34
16"	400	10	406	870	565	515	429	24.5	4	16-φ28
		16	406	870	580	525	480	28	4	16-φ31
		25	406	870	620	550	503	32	4	16-φ37



(Z41X) PN10/PN16/PN25

BS Standard Rising Stem Flanged Joint Ends Resilient Wedge Gate Valves (Z41X) PN10/PN16/PN25

Statement:

The gate valve can seal flow well with its soft wedge. Where the working temperature is $\leq 80^{\circ}\text{C}$. They are widely used in architectonics, edibles, medicine, chemical energy, supplying and draining water industry, etc. It adjusts the water in piping line and in equipments.

MATERIAL SPECIFICATIONS

Standard:
: BS 5163

Connection Ends:
: BS EN 1092-2
Flange: BS EN 1092-2

Drive Style:
Lever handle
Electric drive
Pneumatic drive

Test Pressure:
PN10 Shell:1.5MPa Seal:1.1MPa
PN16 Shell:2.4MPa Seal:1.76MPa
PN25 Shell:3.75MPa Seal:2.75MPa

Applicable Temperature:
 $0^{\circ}\text{C}-80^{\circ}\text{C}$

Surface:
150-500um, AWWA C550
Coating: Akzo Nobel Fusion Bonded Epoxy Coating
with thickness 150-500um, Complies with
ANSI/AWWA C550.

Applications:
Potable water, water supply and drainage,
sewage disposal, irrigation air condition and
fire protection pipe system etc.

Part No.	Part	Specification
1	Valve Body	Ductile Iron QT450-10
2	Resilient Wedge Disc	Ductile Iron QT450-10/EPDM
3	Stem Back Seat O-Ring	EPDM
4	Stem	Stainless Steel Cr13,304,316
5	Nut	Carbon Steel Zinc Plated
6	Bonnet	Ductile Iron QT450-10
7	Stem Bushing	Brass Hpb59-1
8	Gland	Ductile Iron QT450-10
9	Flat Washer	Carbon Steel Zinc Plated
10	Threaded Rod	Carbon Steel Zinc Plated
11	Nut	Carbon Steel Zinc Plated
12	Yoke	Ductile Iron QT450-10
13	Stem Nut	Bronze ZQSn5-5-5 or Brass Hpb59-1
14	Washer	Bronze ZQSn5-5-5 or Brass Hpb59-1
15	Locknut	Malleable Iron KTH300-6 Zinc plated
16	Handwheel	Ductile Iron QT450-10
17	O-Ring	NBR or EPDM
18	Bonnet Gasket	EPDM

Note: The first material is basic configuration. If you have different requirement on accessories, please remark it on inquiry.
Optional accessories: electrical drive, pneumatic drive, stem 2Cr13, stem 304, stem 316, bronze stem nut ZQSn5-5-5, brass stem nut Hpb59-1.



Z41X
Flanged OS&Y gate valve



Z81X
Grooved OS&Y gate valve



Z51X
Flanged+Grooved OS&Y gate valve



Features:

Akzo Nobel Fusion Bonded Epoxy Coating: Inside and Outside, can be used for potable water, food and pharmaceuticals industries with long life.

Material: Ductile Iron Body, Bonnet, Wedge and Handwheel, high strength and corrosion resisting. Valve seat cast with body at the same time, not necessary to machine.

When valve is opened completely, It will have a smooth unobstructed waterway, without groove which will maintain sundries. The same O.D. will not effect fluid medium.

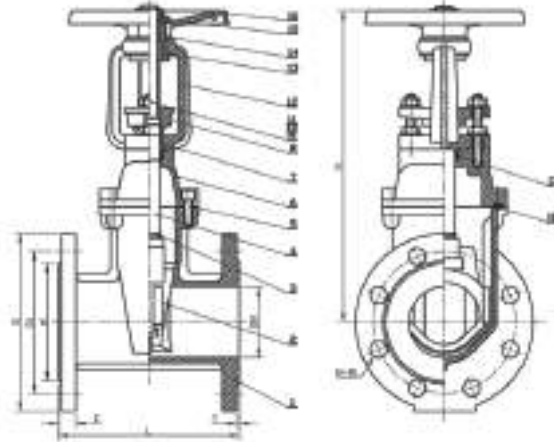

DIMENSIONS

DN		(PN)	Dimensions (mm)								
inch	mm		L	H(close)	H1(open)	D	D1	d	C	T	N-φL
2"	50	10/16	178	257	307	165	125	99	19	3	4-φ19
		25	178	257	307	165	125	99	19	3	4-φ19
2.5"	65	10/16	190	305	370	185	145	118	19	3	4-φ19
		25	190	305	370	185	145	118	19	3	8-φ19
3"	80	10/16	203	350	430	200	160	132	19	3	8-φ19
		25	203	350	430	200	160	132	19	3	8-φ19
4"	100	10/16	229	422	522	220	180	156	19	3	8-φ19
		25	229	422	522	235	190	156	19	3	8-φ23
6"	150	10/16	267	563	713	285	240	211	19	3	8-φ23
		25	267	563	713	300	250	211	20	3	8-φ28
8"	200	10	292	675	875	340	295	266	20	3	8-φ23
		16	292	675	875	340	295	266	20	3	12-φ23
		25	292	675	875	360	310	274	22	3	12-φ28
10"	250	10	330	930	1180	405	350	319	22	3	12-φ23
		16	330	930	1180	405	355	319	22	3	12-φ28
		25	330	930	1180	425	370	330	24.5	3	12-φ31
12"	300	10	356	1050	1350	460	400	370	24.5	4	12-φ23
		16	356	1050	1350	460	410	370	24.5	4	12-φ28
		25	356	1050	1350	485	430	389	27.5	4	16-φ31



(Z41X) 250PSI/300PSI

American Standard Rising Stem Flanged Joint Ends Resilient Wedge Gate Valves
(Z41X) 250PSI/300PSI

Statement:

The gate valve can seal flow well with its soft wedge. Where the working temperature is $\leq 80^{\circ}\text{C}$. They are widely used in architectonics, edibles, medicine, chemical energy, supplying and draining water industry, etc. It adjusts the water in piping line and in equipments.

MATERIAL SPECIFICATIONS

Standard:
AWWA C515

Connection Ends:
ASME B16.1
Flange: ASME B16.1

Drive Style:
Lever handle
Electric drive
Pneumatic drive

Test Pressure:
250PSI Shell: 500PSI Seal: 250PSI
300PSI Shell: 600PSI Seal: 300PSI

Applicable Temperature:
 $0^{\circ}\text{C} - 80^{\circ}\text{C}$

Surface:
150-500um, AWWA C550
Coating: Akzo Nobel Fusion Bonded Epoxy Coating with thickness 150-500um, Complies with ANSI/AWWA C550.

Applications:
Potable water, water supply and drainage, sewage disposal, irrigation air condition and fire protection pipe system etc.

Part No.	Part	Specification
1	Valve Body	Ductile Iron QT450-10
2	Resilient Wedge Disc	Ductile Iron QT450-10/EPDM
3	Stem	Stainless Steel Cr13,304,316
4	Bonnet Gasket	EPDM
5	Bonnet	Ductile Iron QT450-10
6	O-Ring	NBR or EPDM
7	Yoke	Ductile Iron QT450-10
8	Stem Bushing	Hpb59-1
9	Gland	Ductile Iron QT450-10
10	Stem Nut	Bronze ZQSn5-5-5 or Brass Hpb59-1
11	Handwheel	Ductile Iron QT450-10
12	Washer	Bronze ZQSn5-5-5 or Brass Hpb59-1
13	Nut	Carbon Steel Zinc Plated
14	Threaded Rod	Carbon Steel Zinc Plated
15	Flat Washer	Carbon Steel Zinc Plated
16	Bolt	Carbon Steel Zinc Plated
17	Stem Back Seat O-Ring	EPDM

Note: The first material is basic configuration. If you have different requirement on accessories, please remark it on inquiry.
Optional accessories: electrical drive, pneumatic drive, stem 2Cr13, stem 304, stem 316, bronze stem nut ZQSn5-5-5, brass stem nut Hpb59-1.



Z41X
Flanged OS&Y gate valve



Z81X
Grooved OS&Y gate valve



Z51X
Flanged+Grooved OS&Y gate valve



Features:

Akzo Nobel Fusion Bonded Epoxy Coating: Inside and Outside, can be used for potable water, food and pharmaceuticals industries with long life.

Material: Ductile Iron Body, Bonnet, Wedge and Handwheel, high strength and corrosion resisting. Valve seat cast with body at the same time, not necessary to machine.

When valve is opened completely, It will have a smooth unobstructed waterway, without groove which will maintain sundries. The same O.D. will not effect fluid medium.

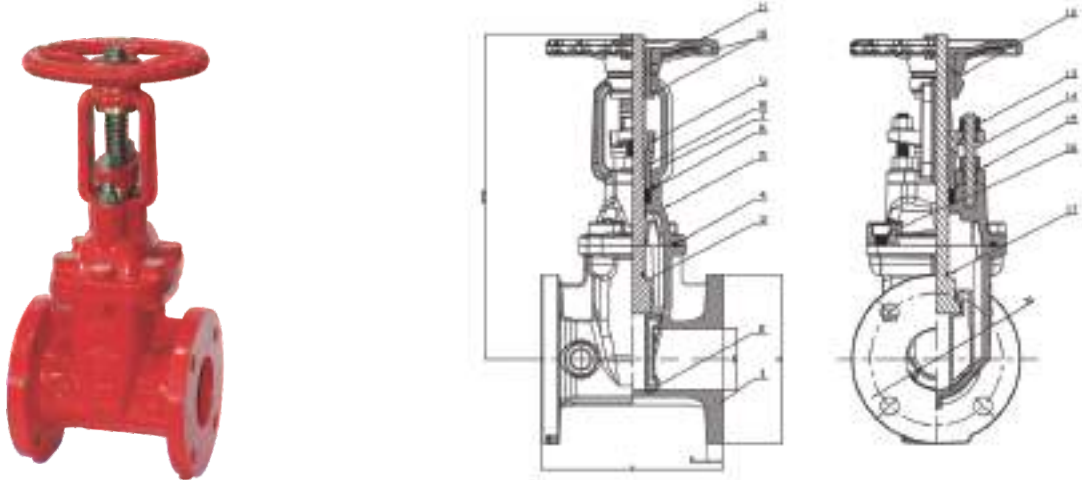

DIMENSIONS

DN		Dimensions(mm)						
inch	mm	L	H(open)	H1(close)	D	D1	C	n-φL
2"	50	178	370	318	152	102.7	16	4-φ19.1
2.5"	65	190	410	343	178	139.7	17.5	4-φ19.1
3"	80	203	468	386	191	152.4	19	8-φ19.1
4"	100	229	538	436	229	190.5	19	8-φ19.1
5"	125	254	640	513	254	215.9	19.1	8-φ22.2
6"	150	267	730	576	279	241.3	19.1	8-φ22.2
8"	200	292	950	749	343	298.5	22.2	8-φ22.2
10"	250	330	1158	904	406	362	23.8	12-φ25.4
12"	300	356	1335	1030	483	431.8	25.4	12-φ25.4



(H44X/H44T) PN10/PN16/PN25

BS Standard Swing Check Valves Flanged Joint Ends,
Rubber Seal (H44X) / Metal Seal (H44T) PN10/PN16/PN25

Statement:

Usage: It can prevent the water from flowing backward.

MATERIAL SPECIFICATIONS

Standard:

: BS EN 12334

Connection Ends:

: BS EN 1092-2

Flange: BS EN 1092-2

Rubber Seal:

Test Pressure:

PN10 Shell:1.5MPa Seal:1.1MPa

PN16 Shell:2.4MPa Seal:1.76MPa

PN25 Shell:3.75MPa Seal:2.75MPa

Applicable Temperature:

0°C—80°C

Metal Seal:

Test Pressure:

PN10Shell:1.5MPa Seal:1.1MPa

PN16Shell:2.4MPa Seal:1.76MPa

PN25 Shell:3.75MPa Seal:2.75MPa

Applicable Temperature:

-10°C—350°C

Surface:

150-500um, AWWA C550

Coating: Akzo Nobel Fusion Bonded Epoxy Coating
with thickness 150-500um,Complies with
ANSI/AWWA C550.

Applications:

Potable water, water supply and drainage.
sewage disposal, irrigation and fire protection,
steam and oil pipe system etc.

Part No.	Part	Specification
1	Valve Body	Ductile Iron QT450-10
2	Seat Ring (press fit)	ASTM B62 or 13Cr
3	Disc	Ductile Iron QT450-10 and EPDM Ductile Iron QT450-10 and Seat Ring
4	Hinge	Ductile Iron QT450-10
5	Washer	Stainless Steel 13Cr
6	Nut	Carbon Steel Zinc Plated
7	Split Pin	Stainless Steel 304
8	Seat Ring Threaded	Brass ASTM B62 or Stainless Steel13Cr
9	Disc Seal Ring	ASTM B62 or 13Cr
10	Hinge Pin	Stainless Steel 13Cr
11	Plug	Malleable Iron Galvanized
12	Bonnet Gasket	Graphite + Steel EPDM
13	Bolts	Carbon Steel Zinc Plated
14	Washer	Carbon Steel Zinc Plated
15	Bonnet	Ductile Iron QT450-10
16	Plug	Malleable Iron Galvanized
17	Sling Ring	Carbon Steel Zinc Plated

Features:

Light body, short on & off distance for disc, small flow resistance.
 Valve can be stopped quickly with good energy-saving results.

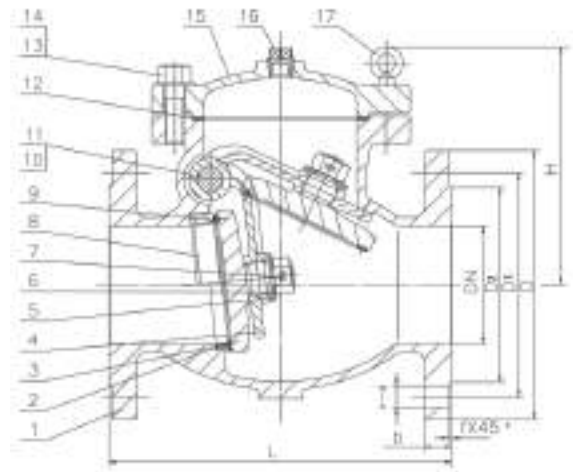

DIMENSIONS

DN		PN	Dimensions (mm)							
inch	mm		L	D	D1	D2	b	n-d	f	H
2"	50	10/16/25	203	165	125	99	19	4-19	3	146
2.5"	65	10/16/25	216	185	145	118	19	4-19	3	155
3"	80	10/16/25	241	200	160	132	19	8-19	3	173
4"	100	10/16	292	220	180	156	19	8-19	3	180
		25	292	235	190	156	19	8-23	3	180
5"	125	10/16	330	250	210	184	19	8-19	3	212
		25	330	270	220	184	19	8-23	3	212
6"	150	10/16	356	285	240	211	19	8-23	3	260
		25	356	300	250	211	20	8-28	3	260
8"	200	10	495	340	295	266	20	8-23	3	290
		16	495	340	295	266	20	12-23	3	290
		25	495	360	310	274	22	12-28	3	290
10"	250	10	622	405	350	319	22	12-23	3	339
		16	622	405	355	319	22	12-28	3	339
		25	622	425	370	330	24.5	12-31	3	339
12"	300	10	698	460	400	370	24.5	12-23	4	376
		16	698	460	410	370	24.5	12-28	4	376
		25	698	485	430	389	27.5	16-31	4	376



(DH77X) PN10/PN16

BS Standard Wafer Butterfly-type Check Valves (DH77X) PN10/PN16

Statement:

The valve can be used on pipe line through which water ≤80°C or other noncorrosive medium to prevent back flow.

MATERIAL SPECIFICATIONS

Standard:

: BS EN 1074-3

Test Pressure:

PN10 Shell:1.5MPa Seal:1.1MPa

PN16 Shell:2.4MPa Seal:1.76MPa

Applicable Temperature:

0°C—80°C

Surface:

150-500um, AWWA C550.

Coating: Akzo Nobel Fusion Bonded Epoxy Coating with thickness 150-500um,Complies with ANSI/AWWA C550.

Applications:

To prevent the medium regorging and diminish noises of potable water, water supply and drainage, sewage disposal, irrigation and fire protection pipe system etc.

Part No.	Part	Specification
1	Valve Body	Ductile Iron QT450-10
2	Disc	Ductile Iron QT450-10 Zinc Plated or Stainless Steel 304
3	Stem	Stainless Steel
4	Spring	Stainless Steel
5	Rubber Seat	EPDM or NBR

Optional accessories: ductile iron disc or stainless steel 304 disc.

Features:

Accelerate closing by lighter body design and use of spring, can reduce the water hammer and sound.
 Short distance between valve's surface than the general check valve makes installation becoming easier in the limit sapce.
 Small size, light weight, reasonable constructure, easy maintenance.
 Can be installed in horizontal or vertical direction pipeline. The valve stem should be perpendicular to the flow direction when installed into horizontal pipeline. On vertical pipeline, the flow direction should be from the bottom to up.

Akzo Nobel Fusion Bonded Epoxy Coating: Inside and Outside, can be used for potable water, food and pharmaceuticals industries with long life.

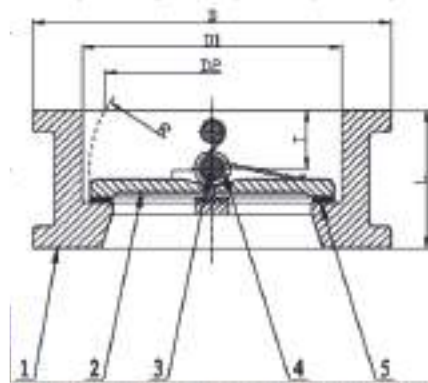

DIMENSIONS

DN		PN	Dimensions (mm)					
inch	mm		L	D	D1	D2	R	t
2"	50	PN10/16	54	107	64	41.6	28.5	19.5
2.5"	65	PN10/16	54	127	78	36.6	36	31
3"	80	PN10/16	57	142	94	67.5	42	25
4"	100	PN10/16	64	162	117	83.5	50	27.5
5"	125	PN10/16	70	192	145	116	66	31.5
6"	150	PN10/16	76	218	170	140.5	77	31.5
8"	200	PN10/16	95	273	224	189.2	102.5	39.5
10"	250	PN10/16	108	328	265	233.7	125	44.5
12"	300	PN10/16	143	378	310	203.6	146	72.5
14"	350	PN10/16	127	438	360	327.87	170	45
16"	400	PN10/16	140	489	410	375.88	195	52
18"	450	PN10/16	152	555	450	414.06	215	58
20"	500	PN10/16	152	594	505	467.83	241	58
24"	600	PN10/16	178	700	624	569.59	294	73

(D71X) PN6/PN10/PN16

Wafer Butterfly Valves (D71X) PN6/PN10/PN16

Statement:

The valve is widely applied to cut off fluid in piping system. It can also be designed, however, to act as adjusting valve or with both functions.

MATERIAL SPECIFICATIONS

Standard:

: BS 5155

: ISO5211

Top flange standard: ISO5211

Drive Style:

Lever handle

Gear handle

Electric drive

Pneumatic drive

Test Pressure:

PN6 Shell:0.9Mpa Seal:0.66MPa

PN10 Shell:1.5MPa Seal:1.1MPa

PN16 Shell:2.4MPa Seal:1.76MPa

Applicable Temperature:

0°C-80°C

Surface:

150-500um, AWWA C550

Coating: Akzo Nobel Fusion Bonded Epoxy

Coating with thickness 150-500um,

Complies with ANSI/AWWA C550.

Applications:

Potable water, water supply and drainage, sewage disposal, irrigation and fire protection pipe system etc.

Part No.	Part	Specification
1	Valve Body	Ductile Iron QT450-10
2	Disc	Ductile Iron QT450-10 Zinc Plated Ductile Iron QT450-10 Nickel Plated Stainless Steel CF8 Carbon Steel Stainless Steel CF8M
3	Stem	Stainless Steel
4	Bushing	NYLON 1010
5	Rubber Seat	EPDM NBR



D71X
Wafer butterfly valve
lever handle



D371X
Wafer butterfly valve
gear handle



D971X
Wafer butterfly valve
electric drive



D671X
Wafer butterfly valve
pneumatic drive

Features:

Small size with light weight design, easy installation and maintenance wherever required.
 Simple and compact construction, quick 90 degrees on-off operation. when it's closed, no leakage under pressure testing.

Minimized operating torque, light force required during operating.
 Flow curve tending to straight line. Excellent regulating performance.
 Long service life, capable of withstanding 10,000 times of on-off testing.
 Widely used for various medium with different accessories.

Akzo Nobel Fusion Bonded Epoxy Coating: Inside and Outside, can be used for potable water, food and pharmaceuticals industries with long life.

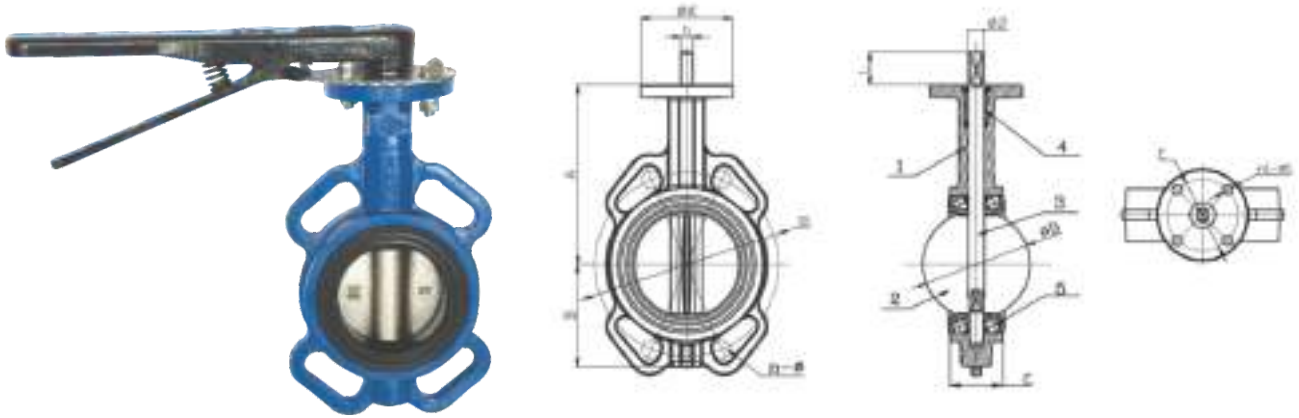

DIMENSIONS

DN		Dimensions (mm)													
inch	mm	A	B	C	D	D1		L	K	E	Φ2	n1-Φ1	n-Φ		G
						1.0	1.6						1.0	1.6	
2"	50	140.5	64.5	43	53.9	125	125	32	90	70	14	4-Φ10	4-Φ19	4-Φ19	9.53
2.5"	65	153	72	46	65.2	145	145	32	90	70	14	4-Φ10	4-Φ19	4-Φ19	9.53
3"	80	153	86	46	79.7	160	160	32	90	70	14	4-Φ10	8-Φ19	8-Φ19	9.53
4"	100	176	100	52	105	180	180	32	90	70	16	4-Φ10	8-Φ19	8-Φ19	11.14
5"	125	191	112	56	130	210	210	32	90	70	16	4-Φ10	8-Φ19	8-Φ19	11.14
6"	150	202.5	128	56	155.8	240	240	32	90	70	20	4-Φ10	8-Φ23	8-Φ23	12.7
8"	200	243.5	162	60	206.7	295	295	45	125	102	26	4-Φ12	8-Φ23	12-Φ23	20.6
10"	250	273	194	68	253.25	350	355	45	125	102	26	4-Φ12	12-Φ23	12-Φ28	20.6
12"	300	311	223	78	301.85	400	410	45	125	102	28	4-Φ12	12-Φ23	12-Φ28	22.1
14"	350	368	267	76.5	333.3	460	470	45	125	102	31.6	4-Φ12	16-Φ23	16-Φ28	22.1
16"	400	400	307	86.5	389.6	515	525	51.2	175	140	33.15	4-Φ18	16-Φ28	16-Φ31	22.1
18"	450	422	328	105.6	440.5	565	585	51.2	175	140	38	4-Φ18	20-Φ28	20-Φ31	27
20"	500	480	361	131.8	491.6	620	650	64.2	175	140	41.15	4-Φ18	20-Φ28	20-Φ34	27
24"	600	562	459	152	592.5	725	770	70.2	210	165	50.65	4-Φ22	20-Φ31	20-Φ37	36
28"	700	624	520	163	695	840	840	66	300	254	63.5	4-Φ18	24-Φ31	24-Φ37	46
32"	800	672	591	188	794.7	950	950	66	300	254	63.5	4-Φ18	24-Φ34	24-Φ41	46
36"	900	720	656	203	864.7	1050	1050	118	300	254	75	4-Φ18	28-Φ34	28-Φ41	55
40"	1000	800	721	216	965	1160	1170	253	300	254	85	4-Φ18	28-Φ37	28-Φ44	55



1. Ductile Iron ASTM A536:

Ductile Iron Body, Bonnet, Wedge and Hand wheel, high strength and corrosion resisting. Valve seat was cast with body at the same time, not necessary to machine.

2. Triple O-ring Stem Seals:

The lower O-ring isolates the stem thrust collar bearing area from the waterway. The upper two O-rings can easily be replaced in the line while the valve is under pressure in the open position.

3. Bonnet Gasket:

Provides superior bonnet seal. (2-12")

4. Stainless Steel Stem and Brass Thrust Collar:

This time-tested design has repeatedly proven its superior strength over cast stems.

5. Fusion Bonded Epoxy Coating:

Inside and Outside, can be used for potable water, food and pharmaceuticals industry with long life.

6. Bronze Wedge Nut:

The nut is electrically isolated from the iron in the wedge for corrosion resistance. The nut is held tightly in place to resist stem binding.

7. Integral Legs:

Flats cast in the bottom of the valve body let the valve stand upright during stocking and installation.





ISO 9001 : 2008



Approved

Ductile Iron Threaded Pipe Fittings ●
◆ Ductile Iron Grooved Fittings ●





EN331
Approved



AN ISO 9001 : 2008
CERTIFIED CO.



INTRODUCTION

We use this opportunity to introduce ourselves as a leading **Manufacturer of Malleable Cast Iron Galvanized Pipe Fittings for Water Supply, Fire Fighting & Natural Gas Distribution for almost most three decades.** We are also into marketing of Forged Brass Valves of various types, for Natural Gas Distribution, Water Supply & Air Conditioning.

We have **certification of Bureau of Indian Standards (BIS / ISI).** To further certify our quality, the process systems as Jainsons Industries are **ISO-9001: 2008 approved by UL - MSS India.**

We have also launched **UL & FM Approved Ductile Iron Pipe Fittings for Fire Fighting** (though these are being used worldwide), which are tested up to 500 psi, much lower than actual pressure carried in Fire Fighting Lines.

Also we can offer Brass Threaded Ball Valves with UL & FM Approval which can be used in Fire Systems Line.

List of few of our clientele in India & abroad will help you identify with our credibility and product quality. We are on the **approved vendor list of following Natural Gas Distribution companies:**

- Egyptian Town Gas, Egypt
- Egypt Gas Co., Egypt
- Gujarat Gas Co. Ltd., Surat
- Mahanagar Gas Ltd., Mumbai
- Indraprastha Gas Ltd., New Delhi
- Adani Gas Ltd., Ahmedabad

To add on to our credibility, we are also on the approved vendor list of **DMRC, i.e. Delhi Metro Rail Corporation, DGS&D, CIDCO Maharashtra and Bhilai Steel Plant, Bhilai.**

We have supplied Malleable Cast Iron Galvanized Pipe Fittings for Fire Fighting Systems to following sub contractors of DMRC:

- ➔ Larsen & Toubro Ltd. (Engineering, Construction & Contracts Division), Delhi
- ➔ Kumagai Skanska HCC Itochu (KSHI) Group (Joint Venture)

We always take care of on time delivery & quality workmanship to satisfy customer needs.

In the light of the above information, **we are sure you will be interested in our pipe fittings and valves for your current & upcoming Projects.**



D.I. Fittings



Brass
Ball Valves



INTRODUCTION

D.I. FITTINGS DUCTILE IRON PIPE FITTINGS



D.I. FITTINGS

90
Elbow, 90°



Size	Inch	1/2"	3/4"	1"	1-1/4"	1-1/2"	2"	2-1/2"	3"		
	mm	15	20	25	32	40	50	65	80		
Dimensions	A	28.5	33.3	38.1	44.5	49.3	57.2	68.6	78.2		

90R
Elbow, 90°, Reducing



Size	Inch	3/4"x1/2"	1"x1/2"	1"x3/4"	1-1/4"x1/2"	1-1/4"x3/4"	1-1/4"x1"	1-1/2"x1/2"	1-1/2"x3/4"	1-1/2"x1"	1-1/2"x1-1/4"	2"x1/2"	2"x3/4"	2"x1"
	mm	20x15	25x15	25x20	32x15	32x20	32x25	40x15	40x20	40x25	40x32	50x15	50x20	50x25
Dimensions	A	30.5	32	34.8	34	36.8	40.1	35.8	38.6	41.9	46.2	37.9	40.6	43.9
	B	31	35.5	36.8	38.9	41.2	42.4	42.2	44.5	45.7	47.8	47.8	50	51.3

130
Tee



Size	Inch	1/2"	3/4"	1"	1-1/4"	1-1/2"	2"	2-1/2"			
	mm	15	20	25	32	40	50	65			
Dimensions	A	28.5	33.3	38.1	44.5	49.3	57.2	68.6			

130R
Tee, Reducing



Size	Inch	3/4"x1/2"	1"x1/2"	1"x3/4"	1-1/4"x1/2"	1-1/4"x3/4"	1-1/4"x1"	1-1/2"x1/2"	1-1/2"x3/4"	1-1/2"x1"	1-1/2"x1-1/4"	2"x1/2"	2"x3/4"	2"x1"	2"x1-1/4"	2"x1-1/2"
	mm	20x15	25x15	25x20	32x15	32x20	32x25	40x15	40x20	40x25	40x32	50x15	50x20	50x25	50x32	50x40
Dimensions	A	30.5	32	34.8	34	36.8	40.1	35.8	38.6	41.9	46.2	37.9	40.6	43.9	48.3	51.3
	B	31	35.5	36.8	38.9	41.2	42.4	42.2	44.5	45.7	47.8	47.8	50	51.3	53.3	54.9

180
Cross

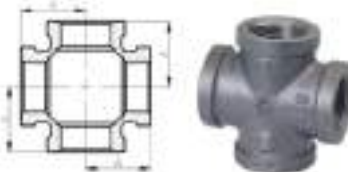

Size	Inch	1"	1-1/4"	1-1/2"	2"					
	mm	25	32	40	50					
Dimensions	A	38.1	44.5	49.3	57.2					

180R
Cross, Reducing



Size	Inch	1-1/4"x1"	1-1/2"x1"												
	mm	32x25	40x25												
Dimensions	A	40.1	41.9												
	B	42.4	45.7												

220
Socket



Size	Inch	1/2"	3/4"	1"	1-1/4"	1-1/2"	2"				
	mm	15	20	25	32	40	50				
Dimensions	A	34	38.6	42.4	48.4	54.6	64.3				



EN331
Approved



AN ISO 9001 : 2008
CERTIFIED CO.



240
Socket,
Reducing

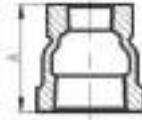

Size	Inch	1"x1/2"	1"x3/4"	1-1/4"x3/4"	1-1/4"x1"	1-1/2"x1"	1-1/2"x1-1/4"	2"x1"	2"x1-1/4"	2"x1-1/2"			
	mm	25x15	25x20	32x20	32x25	40x25	40x32	50x25	50x32	50x40			
Dimensions	A	42.9	42.9	53	52.3	58.7	58.7	71.4	71.4	71.4			

241
Bushing

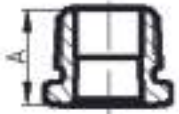

Size	Inch	1"x1/2"	1"x3/4"	1-1/4"x1"	1-1/2"x1"	1-1/2"x1-1/4"	2"x1-1/2"
	mm	25x15	25x20	32x25	40x25	40x32	50x40
Dimensions	A	25.4	25.4	27.4	29	29	31

241N
Bushing

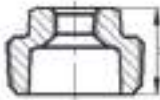

Size	Inch	2"x1"							
	mm	50x25							
Dimensions	A	32.8							

291
Plug

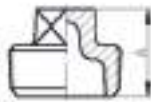

Size	Inch	1/2"	3/4"	1"	1-1/4"	1-1/2"	2"			
	mm	15	20	25	32	40	50			
Dimensions	A	23.9	27.2	31.8	34.5	36.8	39.6			

300
Cap



Size	Inch	1/2"	3/4"	1"	1-1/4"	1-1/2"	2"	2-1/2"		
	mm	15	20	25	32	40	50	65		
Dimensions	A	22.1	24.6	39.5	32.5	33.8	36.8	43.2		

342
Union, conical
joint, Brass to
Iron seat

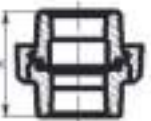

Size	Inch	1"	1-1/4"	1-1/2"	2"					
	mm	25	32	40	50					
Dimensions	A	52.3	57.4	61.2	69.9					

FEATURES



UL Approved
(Under Writer Laboratories, USA)

(Under Writer Laboratories, USA)

UL is the trusted resources across the globe for product safety certification and compliance solutions. Benefitting a range of customers-from manufactures and consumers to regulatory Bodies and code officials we've Tested products for public safety for more than a century.



(World's Best Agency for Fire Fighting Approval)

Approved

(World's Best Agency for Fire Fighting Approval)

Your customers demand quality, and your position in the market place depends on producing quality products. Ensure the quality of your products and protect your market share by obtaining third-party certification from FM Approvals.

The main features of these fittings are that these fittings are :

- UL Approved (Under Writer Laboratories, USA)
- FM Approved (World's Best Agency for Fire Fighting Approval)
- Threaded (Ease of Installation)
- Totally Safe & Leak Proof (Tested at Hydraulic pressure upto 2000psi)
- Accepted World Wide
- 20 – 30% lower in cost than currently used Forged Steel Fittings



Accepted World Wide

Feature	Ductile Iron Fittings	Forged Fittings	Remarks
Internationally Used in Fire Fighting	Yes	No	Internationally Chosen Europe as well as USA
International Approval	Yes, UL & FM	No Approval	FM Approval is basic criterion for Fire Fighting Fittings
Ease of Use & Handling	High, Light Weight	Low, Extra Heavy	Installation Friendly
Test Pressure / Working Pressure	2000 psi/ 500 psi	1000 psi	Why use high pressure fittings when actual pressure is 300 psi or less
Cost / Price	Low, 30-40% cheaper than Forged Fittings	Very High	Do, we need say more.

COMPARISON CHART

Our **UL & FM Approved Ductile Iron Pipe Fittings for Fire Fighting**, are tested up to 2000 psi, whereas actual pressure carried in Fire Fighting Lines is much lower.

Chart shows the comparison between Forged Fittings & Fire Fighting Fittings.

Latest & low cost alternative of Forged Fittings tested up to 2000psi



EN331
Approved



AN ISO 9001 : 2008
CERTIFIED CO.



DUCTILE IRON GROOVED FITTINGS



P.I. GROOVED FITTINGS

<p>1G Rigid Coupling</p> 	<p>1N Flexible Coupling</p> 	<p>1NH Heavy Duty Flexible Coupling</p> 	<p>180 Cross</p> 	<p>240 Grooved Concentric Reducer</p> 
<p>230N Grooved Eccentric Reducer With Female Thread</p> 	<p>321G Adaptor Flange</p> 	<p>321 Grooved Flange</p> 	<p>110 22.5 Elbow</p> 	<p>120 45 Elbow</p> 
<p>90S Light-duty 90° Elbow</p> 	<p>130S Light-duty Tee</p> 	<p>130 Tee</p> 	<p>90 90° Elbow</p> 	<p>90R 90° Reducing Elbow</p> 
<p>300 Cap</p> 	<p>131R Reducing Tee (Threaded Branch)</p> 	<p>130R Reducing Tee (Grooved Branch)</p> 	<p>3J Mechanical Tee Threaded Outlet</p> 	<p>3G Mechanical Tee Grooved Outlet</p> 
<p>105 11.25° Elbow</p> 	<p>3L Small Mechanical Tee U-bolt</p> 	<p>180R Reducing Cross</p> 	<p>181 Reducing Cross</p> 	<p>4G Mechanical Cross Grooved Outlet</p> 
<p>4J Mechanical Cross Threaded Outlet</p> 	<p>240N Grooved Concentric Reducer With Female Thread</p> 	<p>240W Grooved Concentric Reducer With Male Thread</p> 	<p>230 Grooved Eccentric Reducer</p> 	

D.I. GROOVED FITTINGS DUCTILE IRON GROOVED FITTINGS



D.I. GROOVED FITTINGS

1G
Rigid Coupling



Nominal Size	mm/in	size	25	1	32	1 1/4	40	1 1/2	50	2	65	2 1/2	80	3	100	4	100	4	125	5	125	5	125	5		
Pipe O.D.	mm/in		34	1.33	42	1.67	48	1.9	60	2.38	73	2.88	76.1	3	89	3.5	108	4.3	114	4.5	133	5.3	140	5.5	141	5.56
Working Pressure	PSI/MPa		500	3.45	500	3.45	500	3.5	500	3.45	500	3.45	500	3.5	500	3.5	500	3.5	500	3.5	450	3.1	450	3.1	450	3.1
Dimensions	A	mm/in	60	2.35	67	2.64	73	2.9	85	3.35	99	3.9	102	4	116	4.6	141	5.6	146	5.8	167	6.6	172	6.8	172	6.77
	B	mm/in	100	3.94	106	4.17	112	4.4	132	5.2	141	5.53	147	5.8	170	6.7	196	7.7	201	7.9	230	9.1	235	9.3	234	9.21
	C	mm/in	45	1.75	46	1.81	46	1.8	47	1.85	45.5	1.79	45.5	1.8	47	1.9	52	2.1	52.5	2.1	53	2.1	52.5	2.1	52.5	2.07
Bolt Size	No.Size	mm	2-3/8x55		2-3/8x55		2-3/8x55		2-3/8x55		2-3/8x55		2-3/8x55		2-1/2x70		2-1/2x70		2-1/2x70		2-5/8x85		2-5/8x85		2-5/8x85	

1N
Flexible Coupling



Nominal Size	mm/in	size	25	1	32	1 1/4	40	1 1/2	50	2	65	2 1/2	80	3	100	4	100	4	125	5	125	5	125	5	150	6		
Pipe O.D.	mm/in		33.7	1.327	42.4	1.669	48.3	1.9	60.3	2.375	73	2.875	76.1	3	88.9	3.5	108	4.25	114.3	4.5	133	5.25	139.7	5.5	141.3	5.563	159	6.25
Working Pressure	PSI/MPa		500	3.45	500	3.45	500	3.45	500	3.45	500	3.45	500	3.45	500	3.45	500	3.45	500	3.45	450	3.1	450	3.1	450	3.1	450	3.1
Dimensions	A	mm/in	55.5	2.19	65	2.56	72	2.83	84	3.31	98	3.86	101.5	4	115.3	4.55	140	5.51	145.5	5.73	163	6.42	170	6.69	170	6.69	190	7.48
	B	mm/in	94	3.7	104	4.09	109	4.29	130	5.12	143	5.63	148	5.83	165	6.5	198.5	7.82	197	7.75	232	9.13	238.5	9.39	232	9.13	258	10.16
	C	mm/in	42	1.65	45.5	1.79	45.5	1.79	45.5	1.79	45.5	1.79	45.5	1.79	45.5	1.79	50.8	2	50.8	2	51.5	2.03	51.5	2.03	50.8	2	53.5	2.1
Bolt Size	No.Size	mm	2-3/8x55		2-3/8x55		2-3/8x55		2-3/8x55		2-3/8x55		2-1/2x70		2-1/2x70		2-1/2x70		2-5/8x80		2-5/8x80		2-5/8x80		2-5/8x85			

1NH
Heavy Duty Flexible Coupling



Nominal Size	mm/in	size	50	2	65	2 1/2	80	3	100	4	125	5	150	6	150	6	200	8
Pipe O.D.	mm/in		60	2.38	76	3	88.9	3.5	114	4.5	141	5.56	165	6.5	168	6.63	219	8.63
Working Pressure	PSI/MPa		750	5.18	750	5.2	750	5.2	750	5.2	700	4.83	700	4.83	700	4.83	600	4.14
Dimensions	A	mm/in	92	3.6	104	4.1	123	4.8	153	6	181	7.13	207	8.15	210	8.27	269	10.6
	B	mm/in	134	5.28	155	6.1	173	6.8	215	8.5	250	9.85	280	11	285	11.2	355	14
	C	mm/in	46	1.81	46	1.8	47	1.9	51	2	52	2.05	52	2.05	52	2.05	62	2.44
Bolt / Nut	No.Size	mm	2-1/2x75		2-1/2x75		2-1/2x75		2-5/8x85		2-3/4x115		2-3/4x115		2-3/4x115		2-7/8x140	

180
Cross

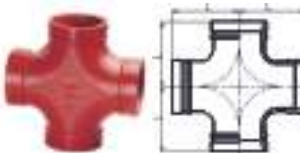

Nominal	Size	mm/in	32	1 1/4	40	1 1/2	50	2	65	2 1/2	80	3	100	4	100	4	125	5	125	5	150	6	150	6	150	6		
Pipe	O.D.	mm/in	42.4	1.66	48.3	1.9	60.3	2.375	73	2.875	76.1	3	88.9	3.5	108	4.25	114.3	4.5	139.7	5.5	141.3	5.563	159	6.25	165.1	6.5	168.3	6.625
Working Pressure	PSI/MPa		500	3.45	500	3.45	500	3.45	500	3.45	500	3.45	500	3.45	500	3.45	500	3.45	500	3.45	500	3.45	500	3.45	500	3.45	500	3.45
Dimensions	L	mm/in	68.85	2.75	69.85	2.75	82.55	3.25	85.25	3.75	101.5	4	108	4.25	127	5	127	5	139.7	5.5	139.7	5.5	165.1	6.5	165.1	6.5	165.1	6.5

240
Grooved Concentric Reducer



Nominal	size	mm/in	32x25	1 1/4x1	40x32	1 1/2x1 1/4	50x32	2x1 1/4	50x40	2x1 1/2	65x50	2 1/2x2	65x40	2 1/2x1 1/2	65x50
Pipe	O.D.	mm/in	42.4x33.7	1.660x1.315	48.3x42.4	1.900x1.660	60.3x42.4	2.375x1.660	60.3x48.3	2.375x1.900	73.0x60.3	2.875x2.375	76.1x48.3	3.000x1.900	76.1x60.3
Working Pressure	PSI/MPa		500	3.45	500	3.45	500	3.45	500	3.45	500	3.45	500	3.45	500
Dimensions	L	mm/in	64	2.5	64	2.5	64	2.5	64	2.5	64	2.5	64	2.5	64

230N
Grooved Eccentric Reducer With Male Thread



Nominal Size	mm/in	size	100x65	108.0x2 1/2	100x65	4x2 1/2	125x80	5x3	150x80	6x3
Pipe	O.D.	mm/in	108.0x76.1	4.250x3.000	114.3x76.1	4.500x3.000	139.7x88.9	5.500x3.500	165.1x88.9	6.500x3.500
Working Pressure	PSI/MPa		500	3.45	500	3.45	500	3.45	500	3.45
Dimensions	L	mm/in	102	4	102	4	127	5	140	5.5



EN331 Approved



AN ISO 9001 : 2008 CERTIFIED CO.



321G Adaptor Flange

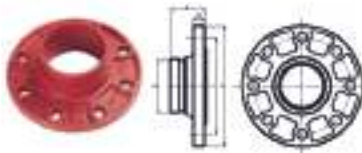

Nominal Size	mm/in	size	40	1 1/2	50	2	65	2 1/2	65	76.1	80	3	100	108	100	4	125	133	125	139.7	125	15	150	159.1	150	165.1	150	6		
Pipe O.D.	mm/in		48.3	1.9	60.3	2.375	73	2.875	76.1	3	88.9	3.5	108	4.25	114.3	4.5	133	5.25	139.7	5.5	141.3	5.563	159	6.25	165.1	6.5	168.3	6.625		
Working Pressure	PSI/MPa		225	1.6	225	1.6	225	1.6	225	1.6	225	1.6	225	1.6	225	1.6	225	1.6	225	1.6	225	1.6	225	1.6	225	1.6	225	1.6		
Dimensions	L	mm/in	60.3	2.375	60.3	2.375	70	2.756	70	2.756	70	2.756	70	2.756	60.3	2.375	76	2.992	60.3	2.375	89	3.5	89	3.5	65.1	2.563	89	3.5	89	3.5
	X	mm	150	5.9	152.5	6	185	7.28	185	7.28	200	7.87	220	8.66	229	9	250	9.84	252	9.921	252	9.921	280	11	280	11	280	11	280	11
	Y	mm	110	4.33	125	4.92	145	5.7	145	5.7	160	6.3	180	7.09	180	7.09	210	8.27	210	8.27	210	8.27	240	9.45	240	9.45	240	9.45	240	9.45
	Z	mm	16	0.63	18	0.71	16	0.63	16	0.63	16	0.63	18	0.71	16	0.63	18	0.71	21	0.83	21	0.83	20	0.78	24	0.94	24	0.94	24	0.94
Bolt / Nut	No.Size	mm	4-M16		4-M16		4-M16		4-M16		8-M16		8-M16		8-M16		8-M16		8-M16		8-M16		8-M20		8-M20		8-M20			

321 Grooved Flange

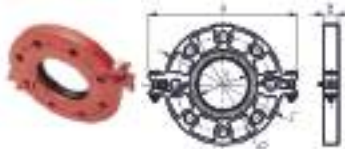

Nominal Size	mm/in	size	40	1 1/2	50	2	65	2 1/2	65	76.1	80	3	100	108	100	4	125	139.7	150	165.1	165	6	200	8	250	10	300	12
Pipe O.D.	mm/in		48.3	1.9	60.3	2.375	73	2.875	76.1	3	88.9	3.5	108	4.25	114.3	4.5	139.7	5.5	165.1	6.5	168.3	6.625	219.1	8.625	273	10.75	323.9	12.75
Working Pressure	PSI/MPa		300	2.07	300	2.07	300	2.07	300	2.07	300	2.07	300	2.07	300	2.07	300	2.07	300	2.07	300	2.07	300	2.07	300	2.07	300	2.07
Dimensions	A	mm/in	195	7.68	220	8.66	235	9.25	235	9.25	245	9.65	280	11.02	280	11.02	320	12.6	346	13.62	346	13.62	414.3	16.31	481.2	18.94	530.5	20.88
	B	mm/in	24	0.95	24	0.95	24	0.95	24	0.95	24	0.95	24	0.95	25.5	1	25.5	1	25.5	1	25.5	1	30	1.18	30	1.19	30	1.19
	C	mm/in	150	5.9	165	6.5	182	7.16	185	7.28	200	7.87	220	8.66	229	9	254	10	280	11	280	11	341.4	13.44	405.6	15.97	460	18.11
	D	mm/in	110	4.33	125	4.92	145	5.71	145	5.71	160	6.3	180	7.09	180	7.09	210	8.27	240	9.45	240	9.45	295	11.61	355	13.98	410	16.14
	E	mm/in	45.4	1.78	57.5	2.26	69.8	2.74	72.7	2.86	85.5	3.37	104.5	4.11	110.5	4.35	135.5	5.33	160.8	6.33	164.3	6.47	214.9	8.46	268.9	10.59	318.9	12.56
Bolt / Nut	No.Size		2-M10x50		2-M10x50		2-M10x50		2-M10x50		2-M10x50		2-M12x55		2-M12x55		2-M12x65		2-M12x65		2-M12x65		2-3/8x70		2-3/8x70		2-3/8x70	

110 22.5° Elbow



Nominal	Size	mm/in	65	2 1/2	80	3	100	4	100	4	125	5	150	6	150	6	150	6	200	8
Pipe	O.D.	mm/in	76.1	3	88.9	3.5	108	4.25	114.3	4.5	139.7	5.5	159	6.25	165.1	6.5	168.3	6.625	219.1	8.625
Working Pressure	PSI/MPa		500	3.45	500	3.45	500	3.45	500	3.45	500	3.45	500	3.45	500	3.45	500	3.45	500	3.45
Dimensions	L	mm/in	51	2.01	57	2.24	73	2.87	73	2.87	79	3.11	79	3.11	79	3.11	79	3.11	79	3.11

120 45° Elbow



Nominal	Size	mm/in	25	1	32	1 1/4	40	1 1/2	50	2	65	2 1/2	65	2 1/2	80	3	100	4	100	4	125	5	150	6	150	6	150	6	200	8	150	6
Pipe	O.D.	mm/in	33.7	1.315	42.4	1.66	48.3	1.9	60.3	2.375	73	2.875	76.1	3	88.9	3.5	108	4.25	114.3	4.5	133	5.25	139.7	5.5	141.3	5.563	165.1	6.5	168.3	6.625	219.1	8.625
Working Pressure	PSI/MPa		500	3.45	500	3.45	500	3.45	500	3.45	500	3.45	500	3.45	500	3.45	500	3.45	500	3.45	500	3.45	500	3.45	500	3.45	500	3.45	500	3.45	500	3.45
Dimensions	L	mm/in	44.45	1.75	44.45	1.75	44.45	1.75	50.8	2	57.15	2.25	57.15	2.25	63.5	2.5	80	3.15	76.2	3	82.5	3.25	82.5	3.25	82.5	3.25	95	3.75	89			

90S Light-duty 90° Elbow

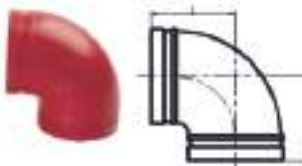

Nominal	Size	mm/in	50	2	65	2 1/2	65	2 1/2	80	3	100	4	100	4	125	5	150	6	150	6	150	6	200	8	200	8
Pipe	O.D.	mm/in	60.3	2.375	73	2.875	76.1	3	88.9	3.5	108	4.25	114.3	4.5	139.7	5.5	159	6.25	165.1	6.5	168.3	6.625	219.1	8.625	219.1	8.625
Working Pressure	PSI/MPa		300	2.07	300	2.07	300	2.07	300	2.07	300	2.07	300	2.07	300	2.07	300	2.07	300	2.07	300	2.07	300	2.07	300	2.07
Dimensions	90S Light-duty 90 Elbow	L	69.85	2.75	76.2	3	76.2	3	85.85	3.38	101.6	4	101.6	4	123.95	4.88	139.7	5.5	139.7	5.5	139.7	5.5	174.5	6.87	174.5	6.87
	130S Light-duty Tee	L	69.85	2.75	76.2	3	76.2	3	85.85	3.38	101.6	4	101.6	4	123.95	4.88	139.7	5.5	139.7	5.5	139.7	5.5	174.5	6.87	174.5	6.87

130S Light-duty Tee

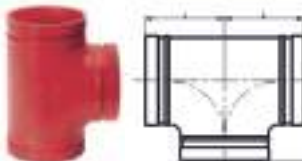

Nominal	Size	mm/in	50	2	65	2 1/2	65	2 1/2	80	3	100	4	100	4	125	5	150	6	150	6	150	6	200	8	200	8
Pipe	O.D.	mm/in	60.3	2.375	73	2.875	76.1	3	88.9	3.5	108	4.25	114.3	4.5	139.7	5.5	159	6.25	165.1	6.5	168.3	6.625	219.1	8.625	219.1	8.625
Working Pressure	PSI/MPa		300	2.07	300	2.07	300	2.07	300	2.07	300	2.07	300	2.07	300	2.07	300	2.07	300	2.07	300	2.07	300	2.07	300	2.07
Dimensions	90S Light-duty 90 Elbow	L	69.85	2.75	76.2	3	76.2	3	85.85	3.38	101.6	4	101.6	4	123.95	4.88	139.7	5.5	139.7	5.5	139.7	5.5	174.5	6.87	174.5	6.87
	130S Light-duty Tee	L	69.85	2.75	76.2	3	76.2	3	85.85	3.38	101.6	4	101.6	4	123.95	4.88	139.7	5.5	139.7	5.5	139.7	5.5	174.5	6.87	174.5	6.87

130 Tee

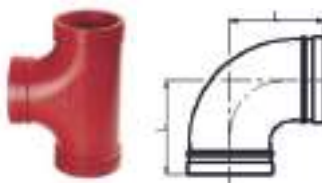

Nominal	Size	mm/in	25	1	32	1 1/4	40	1 1/2	50	2	65	2 1/2	65	2 1/2	80	3	100	4	100	4	125	5	150	6	150	6	150	6	200	8	150	6
Pipe	O.D.	mm/in	33.7	1.315	42.4	1.66	48.3	1.9	60.3	2.375	73	2.875	76.1	3	88.9	3.5	108	4.25	114.3	4.5	133	5.25	139.7	5.5	141.3	5.563	165.1	6.5	168.3	6.625	219.1	8.625
Working Pressure	PSI/MPa		500	3.45	500	3.45	500	3.45	500	3.45	500	3.45	500	3.45	500	3.45	500	3.45	500	3.45	500	3.45	500	3.45	500	3.45	500	3.45	500	3.45	500	3.45
Dimensions	90 90 Elbow	L	57.15	2.25	69.85	2.75	69.85	2.75	82.55	3.25	95.25	3.75	95.25	3.75	107.95	4.25	127	5	122	4.8	139.7	5.5	139.7	5.5	165.1	6.5	165.1	6.5				
	130 "Tee	L	57.15	2.25	69.85	2.75	69.85	2.75	82.55	3.25	95.25	3.75	95.25	3.75	107.95	4.25	127	5	122	4.8	139.7	5.5	139.7	5.5	165.1	6.5	165.1	6.5				

D.I. GROOVED FITTINGS DUCTILE IRON GROOVED FITTINGS



D.I. GROOVED FITTINGS

90
90°
Elbow

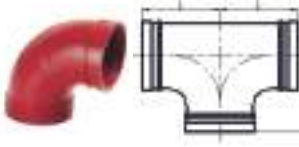

Nominal	Size	mm/in	25	1	32	1 1/4	40	1 1/2	50	2	65	2 1/2	80	3	100	4	125	5	125	5	125	5	150	6	150	6		
Pipe	O.D.	mm/in	33.7	1.315	42.4	1.66	48.3	1.9	60.3	2.375	73	2.875	76.1	3	88.9	3.5	114.3	4.5	133	5.25	139.7	5.5	141.3	5.563	165.1	6.5	168.3	6.625
Working Pressure	PSI/MPa		500	3.45	500	3.45	500	3.45	500	3.45	500	3.45	500	3.45	500	3.45	500	3.45	500	3.45	500	3.45	500	3.45	500	3.45	500	3.45
90 90 Elbow		L	57.15	2.25	69.85	2.75	69.85	2.75	82.55	3.25	95.25	3.75	95.25	3.75	107.95	4.25	127	5	122	4.8	139.7	5.5	139.7	5.5	165.1	6.5	165.1	6.5
130 "Tee		L	57.15	2.25	69.85	2.75	69.85	2.75	82.55	3.25	95.25	3.75	95.25	3.75	107.95	4.25	127	5	122	4.8	139.7	5.5	139.7	5.5	165.1	6.5	165.1	6.5

90R
90°
Reducing
Elbow

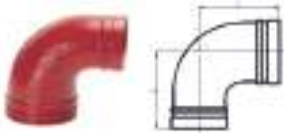

Nominal	Size	mm/in	80x65	3x2 1/2	100x65	4x2 1/2	100x80	4x3	150x150	6x4	150x100	6x4
Pipe	O.D.	mm/in	88.9x76.1	3.500x3.000	114.3x76.1	4.500x3.000	114.3x88.9	4.500x3.500	165.1x114.3	6.500x4.500	168.3x114.3	6.625x4.500
Working Pressure	PSI/MPa		500	3.45	500	3.45	500	3.45	500	3.45	500	3.45
Dimensions	L	mm/in	108	4.25	127	5	127	5	165	6.5	165	6.5

105
11.25°
Elbow



Nominal	Size	mm/in	50	2	65	2 1/4	80	3	100	4	100	4	125	5	150	6	150	6	150	6	150	6	200	8
Pipe	O.D.	mm/in	60.3	2.375	76.1	3	88.9	3.5	108	4.25	114.3	4.5	139.7	5.5	159	6.25	165.1	6.5	168.3	6.625	219	8.625	219	8.625
Working Pressure	PSI/MPa		500	3.45	500	3.45	500	3.45	500	3.45	500	3.45	500	3.45	500	3.45	500	3.45	500	3.45	500	3.45	500	3.45
Dimensions	mm/in	L	35	1.38	38	1.506	38	1.5	44	1.73	44	1.73	51	2.01	51	2.01	51	2.01	51	2.01	51	2.01	51	2.01

300
Cap

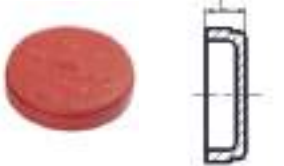

Nominal	Size	mm/in	25	1	32	1 1/4	40	1 1/2	50	2	65	2 1/2	80	3	100	4	100	4	125	5	150	6	150	6	150	6	200	8
Pipe	O.D.	mm/in	33.7	1.315	42.4	1.66	48.3	1.9	60.3	2.375	73	2.875	76.1	3	88.9	3.5	108	4.25	114.3	4.5	139.7	5.5	141.3	5.563	165.1	6.5	168.3	6.625
Working Pressure	PSI/MPa		500	3.45	500	3.45	500	3.45	500	3.45	500	3.45	500	3.45	500	3.45	500	3.45	500	3.45	500	3.45	500	3.45	500	3.45	500	3.45
Dimensions	L	mm/in	22.1	0.87	25.5	1	25.5	1	25.5	1	25.5	1	25.5	1	25.5	1	27	1.06	27	1.06	27	1.06	27	1.06	27	1.06	27	1.06

131R
Reducing
Tee
Threaded Branch



Nominal	Size	mm/in	50x25	2x1	50x32	2x1 1/4	50x40	2x1 1/2	65x25	2x1 1/4	65x32	2x1 1/4	65x25	2x1 1/4	65x32	2x1 1/4	65x25	2x1 1/4	65x32	2x1 1/4	65x25	2x1 1/4	65x32	2x1 1/4	
Pipe	O.D.	mm/in	60.3x33.7	2.375x1.315	60.3x42.4	2.375x1.660	60.3x48.3	2.375x1.900	73.0x48.3	2.875x1.900	73.0x33.7	2.875x1.315	73.0x42.4	2.875x1.660	76.1x33.7	3.000x1.315	76.1x42.4	3.000x1.315	76.1x42.4	3.000x1.660	76.1x48.3	3.000x1.315	76.1x42.4	3.000x1.660	76.1x48.3
Working Pressure	PSI/MPa		300	2.07	300	2.07	300	2.07	300	2.07	300	2.07	300	2.07	300	2.07	300	2.07	300	2.07	300	2.07	300	2.07	300
Dimensions	mm/in	L1	82.5	3.25	82.5	3.25	82.5	3.25	82.5	3.25	76	2.99	76	2.99	76	2.99	76	2.99	76	2.99	76	2.99	76	2.99	95
		L2	82.5	3.25	82.5	3.25	82.5	3.25	82.5	3.25	76	2.99	76	2.99	76	2.99	76	2.99	76	2.99	76	2.99	76	2.99	95

130R
Reducing
Tee
Grooved Branch

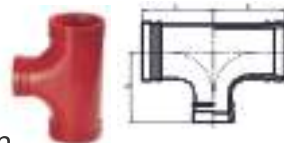

Nominal	Size	mm/in	50x25	2x1	50x40	2x1 1/2	65x40	2x1 1/2	65x50	2x1 1/2	65x32	2x1 1/4	65x40	2x1 1/4	65x40	2x1 1/4
Pipe	O.D.	mm/in	60.3x33.7	2.375x1.315	60.3x48.3	2.375x1.900	73.0x48.3	2.875x1.900	73.0x60.3	3.000x2.375	76.1x42.4	3.000x1.660	76.1x48.3	3.000x1.660	76.1x48.3	3.000x1.900
Working Pressure	PSI/MPa		500	3.45	500	3.45	500	3.45	500	3.45	500	3.45	500	3.45	500	3.45
Dimensions	L	mm/in	82.5	3.25	82.5	3.25	101.5	4	101.5	4	101.5	4	101.5	4	101.5	4

3J
Mechanical
Tee
Threaded
Outlet

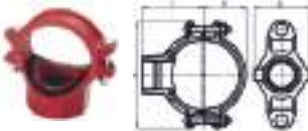

Nominal	Size	mm/in	50x15	2x1/2	50x20	2x1/2	50x25	2x1	50x32	2x1 1/4	50x40	2x1 1/4	65x20	2x1 1/2
Pipe	O.D.	mm/in	60.3x21.3	2.375x0.825	60.3x26.9	2.375x1.050	60.3x33.7	2.375x1.315	60.3x42.4	2.375x1.660	60.3x48.3	2.375x1.900	73.0x26.9	2.875x1.050
Working Pressure	PSI/MPa		300	2.07	300	2.07	300	2.07	300	2.07	300	2.07	300	2.07
Hole Dia	mm/in		38	1.5	38	1.5	38	1.5	45	1.75	45	1.75	38	1.5
Dimensions	mm/in		116	4.57	116	4.57	116	4.57	116	4.57	116	4.57	144	5.67
			68	2.68	68	2.68	68	2.68	76	2.99	76	2.99	71	2.76
			60	2.36	60	2.36	60	2.36	65	2.56	65	2.56	75	2.72
			39	1.54	39	1.54	39	1.54	39	1.54	39	1.54	49	1.93
Bolt Size		3/8x55		3/8x55		3/8x55		3/8x55		3/8x55		1/2x60		

3G
Mechanical
Tee
Grooved
Outlet

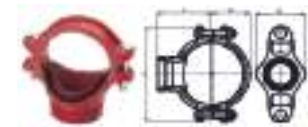

Nominal	Size	mm/in	50x32	2x1 1/4	50x40	2x1 1/2	65x32	2x1 1/4	65x25	76.1x1	65x32	76.1x1 1/4	65x40	76.1x1 1/4	80x25	3x1	80x32
Pipe	O.D.	mm/in	60.3x42.4	2.375x1.660	60.3x48.3	2.375x1.900	73.0x42.4	2.875x1.660	76.1x33.7	3.000x1.315	76.1x42.4	3.000x1.660	76.1x48.3	3.000x1.900	88.9x33.7	3.500x1.315	88.9x42.4
Working Pressure	PSI/MPa		300	2.07	300	2.07	300	2.07	300	2.07	300	2.07	300	2.07	300	2.07	300
Hole Dia	mm/in		45	1.75	45	1.75	51	2	38	1.5	51	2	51	2	38	1.5	51
Dimensions	mm/in		116	4.57	116	4.57	144	5.67	137	5.39	137	5.39	137	5.39	152	5.98	152
			76	2.99	76	2.99	84.5	3.33	71	2.8	84.5	3.33	84.5	3.33	72.5	2.85	85.5
			69.5	2.74	69.5	2.74	75	2.95	78	3.07	78	3.07	78	3.07	84.5	3.33	84.5
			39	1.54	39	1.54	49	1.93	49.5	1.95	49.5	1.95	49.5	1.95	56.5	2.22	56.5
Bolt Size		3/8x55		3/8x55		1/2x60		1/2x75		1/2x75		1/2x75		1/2x75		1/2x75	



EN331 Approved



AN ISO 9001 : 2008 CERTIFIED CO.



3L
Small
Mechanical
Tee U-bolt



Nominal Size	mm/in	size	40	1 1/2	50	2	65	2 1/2	65	76.1	80	3	100	108	100	4	125	133	125	139.7	125	15	150	159.1	150	165.1	150	6
Pipe O.D.	mm/in		48.3	1.9	60.3	2.375	73	2.875	76.1	3	88.9	3.5	108	4.25	114.3	4.5	133	5.25	139.7	5.5	141.3	5.563	159	6.25	165.1	6.5	168.3	6.625
Working Pressure	PSI/MPa		225	1.6	225	1.6	225	1.6	225	1.6	225	1.6	225	1.6	225	1.6	225	1.6	225	1.6	225	1.6	225	1.6	225	1.6	225	1.6
Dimensions	L	mm/in	60.3	2.375	60.3	2.375	70	2.756	70	2.756	70	2.756	60.3	2.375	76	2.992	60.3	2.375	89	3.5	89	3.5	65.1	2.563	89	3.5	89	3.5
	X	mm/in	150	5.9	152.5	6	185	7.28	185	7.28	200	7.87	220	8.66	229	9	250	9.84	252	9.921	252	9.921	200	7.87	200	7.87	200	7.87
	Y	mm/in	110	4.33	125	4.92	145	5.7	145	5.7	160	6.3	180	7.09	180	7.09	210	8.27	210	8.27	210	8.27	240	9.45	240	9.45	240	9.45
	Z	mm/in	16	0.63	18	0.71	16	0.63	16	0.63	16	0.63	18	0.71	16	0.63	18	0.71	21	0.83	21	0.83	20	0.78	24	0.94	24	0.94
Bolt / Nut	No.Size	mm/in	4-M16		4-M16		4-M16		4-M16		8-M16		8-M16		8-M16		8-M16		8-M16		8-M16		8-M20		8-M20		8-M20	

180
Reducing
Cross



Nominal	Size	mm/in	65x50	2 1/2x2	80x50	3x2	100x50	4x2	100x80	4x3	125x100	5x4	150x50	6x2
Pipe	O.D.	mm/in	76.1x60.3	3.000x2.375	88.9x60.3	3.500x2.375	114.3x60.3	4.500x2.375	114.3x88.9	4.500x3.500	139.7x114.3	5.500x4.500	165.1x60.3	6.500x2.375
Working Pressure	PSI/MPa		500	3.45	500	3.45	500	3.45	500	3.45	500	3.45	500	3.45
Dimensions	L	mm/in	101.5	4	108	4.25	127	5	127	5	140	5.5	165	6.5
Dimensions	L1	mm/in	101.5	4	108	4.25	127	5	127	5	140	5.5	165	6.5

181
Reducing
Cross

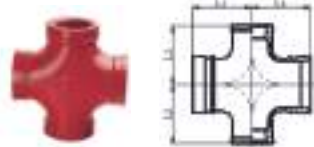

Nominal	Size	mm/in	65x50	2 1/2x2	80x32	3x1 1/2	80x40	3x1 1/2	80x50	3x2	100x25	4x1	100x32	4x1 1/2
Pipe	O.D.	mm/in	76.1x60.3	3.000x2.375	88.9x42.4	3.500x1.660	88.9x48.3	3.500x1.900	88.9x60.3	3.500x2.375	114.3x33.7	4.500x1.315	114.3x42.4	4.500x1.660
Working Pressure	PSI/MPa		300	2.07	300	2.07	300	2.07	300	2.07	300	2.07	300	2.07
Dimensions	L1	mm/in	101.5	4	108	4.25	108	4.25	108	4.25	76	2.99	76	2.99
	L2	mm/in	101.5	4	108	4.25	108	4.25	108	4.25	88	3.47	88	3.47

4G
Mechanical
Cross
Grooved
Outlet

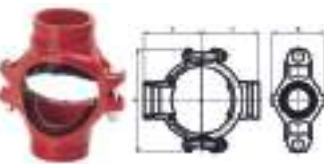

Nominal	Size	mm/in	65x25	76.1x1	66x32	76.1x1 1/2	65x40	76.1x1 1/2	80x25	3x1	80x32	3x1 1/2	80x40	3x1 1/2
Pipe	O.D.	mm/in	76.1x33.7	3.000x1.315	76.1x42.4	3.000x1.660	76.1x48.3	3.000x1.900	88.9x33.7	3.500x1.315	88.9x42.4	3.500x1.660	88.9x48.3	3.500x1.900
Working Pressure	PSI/MPa		300	2.07	300	2.07	300	2.07	300	2.07	300	2.07	300	2.07
Hole Dia	mm/in	+1.6.0/ +0.063	38	1.5	51	2	51	2	38	1.5	51	2	51	2
Dimensions	mm/in	A	137	5.39	137	5.39	137	5.39	152	5.98	152	5.98	152	5.98
		B	71	2.8	84.5	3.33	84.5	3.33	72.5	2.85	85.5	3.37	85.5	3.37
		C	78	3.07	78	3.07	78	3.07	84.5	3.33	84.5	3.33	84.5	3.33
		D	49.5	1.95	49.5	1.95	49.5	1.95	56.5	2.22	56.5	2.22	56.5	2.22
Bolt Size			1/2x75		1/2x75		1/2x75		1/2x75		1/2x75		1/2x75	

4J
Mechanical
Cross
Threaded
Outlet



Nominal	Size	mm/in	50x25	2x1	50x32	2x1 1/2	50x32x25	2x1 1/2x1	50x40	2x1 1/2	50x40x25	2x1 1/2x1	65x25	2 1/2x1	65x32	2 1/2x1 1/2
Pipe	O.D.	mm/in	60.3x33.7	2.375x1.315	60.3x42.4	2.375x1.660	60.3x42.4	2.375x1.660	60.3x48.3	2.375x1.900	60.3x48.3	2.375x1.900	73.0x33.7	2.875x1.315	73.0x42.4	2.875x1.660
Working Pressure	PSI/MPa		300	2.07	300	2.07	300	2.07	300	2.07	300	2.07	300	2.07	300	2.07
Hole Dia	mm/in	+1.6.0/ +0.063	38	1.5	45	1.75	45/38	1.75/1.50	45	1.75	45/38	1.75/1.50	38	1.5	51	2
Dimensions	mm/in	A	116	4.57	116	4.57	116	4.57	116	4.57	116	4.57	144	5.67	144	5.67
		B	68	2.68	76	2.99	76	2.99	76	2.99	76	2.99	70	2.76	84.5	3.33
		C	60	2.36	65	2.56	65	2.56	65	2.56	65	2.56	69	2.72	73	2.87
		D	60	2.36	65	2.56	60	2.36	65	2.56	60	2.36	69	2.72	73	2.87
Bolt Size			3/8x55		3/8x55		3/8x55		3/8x55		3/8x55		1/2x60		1/2x60	

240N
Grooved
Concentric
Reducer With
Female Thread

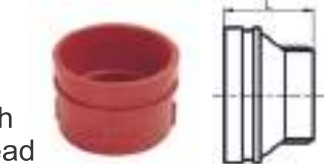

Nominal Size	Grooved Thread	mm/in	50x15	2x1/2	50x20	2x3/4	50x25	2x1	50x32	2x1 1/2	50x40	2x1 1/2	65x25	2 1/2x1
Pipe	O.D.	mm/in	60.3x21.3	2.375x0.825	60.3x26.9	2.375x1.05	60.3x33.7	2.375x1.315	60.3x42.4	2.375x1.660	60.3x48.3	2.375x1.900	73.0x33.7	2.875x1.315
Working Pressure	PSI/MPa		500	3.45	500	3.45	500	3.45	500	3.45	500	3.45	500	3.45
Dimensions	L	mm/in	64	2.5	64	2.5	64	2.5	64	2.5	64	2.5	64	2.5

240W
Grooved
Concentric
Reducer With
Male Thread



Nominal Size	mm/in	Size	65x50	2 1/2x2	65x50	2 1/2x2	80x25	3x1	100x50	4x2	200x150	8x6
Pipe	O.D.	mm/in	73.0x60.3	2.875x2.375	76.1x60.3	3.000x2.375	88.9x33.7	3.500x1.315	114.3x60.3	4.500x2.375	219.1x168.3	8.625x6.625
Working Pressure	PSI/MPa		500	3.45	500	3.45	500	3.45	500	3.45	500	3.45
Dimensions	L	mm/in	64	2.5	64	2.5	64	2.5	76	3	127	5

230
Grooved
Eccentric
Reducer



Nominal Size	mm/in	Size	80x50	3x2	100x65	4x2 1/2	100x80	4x3	100x65	4x2 1/2	100x80	4x3	125x100	5x4	150x100	6x4	150x100
Pipe	O.D.	mm/in	88.9x60.3	3.500x2.375	108.0x76.1	4.250x3.000	108.0x88.9	4.250x3.500	114.3x76.1	4.500x3.000	114.3x88.9	4.500x3.500	139.7x114.3	5.500x4.500	150.0x108.0	6.250x4.250	150.0x114.3
Working Pressure	PSI/MPa		500	3.45	500	3.45	500	3.45	500	3.45	500	3.45	500	3.45	500	3.45	500
Dimensions	L	mm/in	89	3.5	102	4	102	4	102	4	102	4	127	5	140	5.5	140



MCI GALVANIZED PIPE FITTINGS



OTHER PRODUCTS:

D.I. SCREWED PIPE FITTINGS, FORGED BRASS VALVES
GROOVED FITTINGS





• MCI GALVANIZED PIPE FITTINGS, FORGED BRASS VALVES

• D.I. PIPE FITTINGS



GROOVED FITTINGS

TECHNICAL INFORMATION

MATERIAL

JSI Brand pipe fittings are made of black heart malleable cast iron as per IS:14329. JSI Pipe Fittings are also available in SG Iron (Ductile) as per IS-1865 GR SG 370/17.

THREAD

JSI Brand class 150 plain pipe fittings :

IS 554, BS 21 and BSPT, ISO 7 & NPT as per ANSI B1.20.1-1983

Banded JSI pipe fittings available in BSPT, ISO 7 & NPT Thread.

FINISH

Hot dip galvanized as per IS 4759.

PRESSURE - TEMPERATURE RATINGS

Pressure - temperature rating are shown in the following tables.

STANDARD CLASS 150, FITTINGS AND UNIONS

FLUIDS	TEMPERATURE	MAXIMUM WORKING PRESSURE
Water, Non Shock Pressure	250°F/120°C	300psi/21kg/cm ²
Stream, Air, Gas, Oil and Water	400/200	200/14
Stream, Air, Gas and Oil	570/300	150/10.5



STANDARD PACKING

NUMBER OF PIECES PER BAG

S.No.	ITEMS	1/2"	3/4"	1"	1¼"	1½"	2"	2½"	3"	4"
1.	ELBOWS	500	400	250	150	100	70	40	30	18
2.	TEES	400	250	170	100	70	40	25	20	10
3.	UNIONS	300	200	160	100	80	50	30	25	14
4.	SOCKETS	600	500	350	220	180	100	70	40	25
5.	PLUGS	1000	1000	800	500	300	150	110	70	40
6.	HEX NIPPLES	600	500	300	200	175	100	70	40	20
7.	CROSSES	300	225	140	70	50	45	45	45	45
8.	THREE WAY ELBOWS	400	300	200	100	70	45	45	45	45
9.	FOUR WAY TEES	300	200	110	70	50	45	45	45	45
10.	G.I. BENDS	300	200	150	65	50	30	20	10	6

WALL THICKNESS & TOLERANCES

SIZE DESIGNATION	1/2"	3/4"	1"	1¼"	1½"	2"	2½"	3"	4"	5"	6"
Thickness in mm	2.5	3.0	3.0	3.5	3.5	4.0	4.5	5.0	6.0	6.5	7.5
Tolerances in mm	-0.5	-0.7	-0.7	-0.7	-0.7	-0.7	-1.0	-1.0	-1.0	-1.0	-1.0

GAS SOUNDNESS

Banded Pipe Fittings for gas are made in BSPT or NPT thread & are individually tested fully immersed in water at a Pneumatic Pressure of 10.5Kg./CM²/150 PSI.

HYDROTESTING

Plain Pipe Fittings for water are hydrotested at 21 Kg/cm² as per sampling plan for a particular batch of fittings.

MALLEABLE IRON PIPE FITTINGS



S.No.	FIG. No.	ITEM	SIZE
1.	1090	Elbows, plain, equal (L)	1/2" upto 6"
2.	90	Elbows, banded, equal (BL)	1/2" upto 6"
3.	1090R	Elbows reducing (Plain)	1/2" upto 4"
4.	92	Street Elbows, banded, equal (SL) M & F	1/2" upto 2"
5.	1221	Side Outlet Elbows, plain (SOL)	1/2" upto 4"
6.	1130	Tees, plain, equal (T)	1/2" upto 6"
7.	130	Tees, banded, equal (BT)	1/2" upto 6"
8.	1130R	Tees Reducing, plain, (BRT)	3/4"x1/2" upto 6"x4"
9.	1223	Side Outlet Tees, plain (SOT)	1/2" upto 2"
10.	180	Crosses, equal (BCr)	1/2" upto 6"
11.	301	Caps, banded (BCa)	1/2" upto 4"
12.	1220	Sockets (Coupling), plain, with ribs (S)	1/2" upto 6"
13.	220	Sockets (Coupling), banded with ribs (BS)	1/2" upto 6"
14.	240	Reducing Sockets, banded with ribs (BRS)	3/4"x1/2" upto 6"x4"
15.	1240	Reducing Sockets, plain, with ribs (RS)	3/4"x1/2" upto 6"x4"
16.	241	Hexagon Bushes or Bushings (Bu)	3/4"x1/2" upto 4"x3"
17.	291	Plugs (P)	1/2" upto 6"
18.	330	Unions, standard, flat seat with gasket (U)	1/2" upto 6"
19.	280	Hexagonal Nipples (HxNi)	1/2" upto 6"
20.	1	Bends, M. & F. banded, 90° (BMBe) Short	1/2" upto 4"
21.	321	Floor Flanges (FF) Drilled	1/2" upto 6"
22.	97	Union Elbows, Gasket type, Flat seat, Male and Female, without gasket (MULG)	1/2" upto 1 1/4"
23.	310	Backnuts or Locknuts (LN)	1/2" upto 4"

ELBOW BANDED EQUAL (BL)

90

Available in BSP / BSPT & NPT Threads
 Leakage, Corrosion and rust resistant
 Ideal option for high pressure applications
 High durability & Superior finish
 High tensile strength

Applications: Irrigation, Water supply, Plumbing,
 Water wells and Cold Storage applications, Fire Fighting & Gas distribution

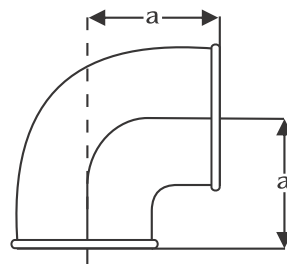

SIZE	1/2"	3/4"	1"	1 1/4"	1 1/2"	2"	2 1/2"	3"	4"	5"	6"				
A	28.00	33.00	38.00	45.00	50.00	58.00	69.00	78.00	96.00	115.00	131.00				



ELBOW EQUAL (HBL)

1090

Available in BSP / BSPT & NPT Threads
Leakage, Corrosion and rust resistant
Ideal option for high pressure applications
High durability & Superior finish
High tensile strength

Applications: Irrigation, Water supply, Plumbing,
Water wells and Cold Storage applications, Fire Fighting & Gas distribution

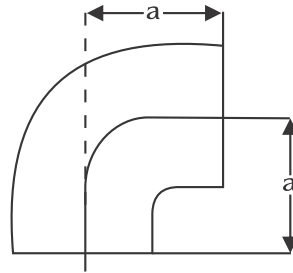

SIZE	1/2"	3/4"	1"	1 1/4"	1 1/2"	2"	2 1/2"	3"	4"	5"	6"				
A	28.00	33.00	38.00	45.00	50.00	58.00	69.00	78.00	96.00	115.00	131.00				

ELBOW REDUCING (HBRL)

1090R

Available in BSP / BSPT & NPT Threads
Leakage, Corrosion and rust resistant
Ideal option for high pressure applications
High durability & Superior finish
High tensile strength

Applications: Irrigation, Water supply, Plumbing,
Water wells and Cold Storage applications, Fire Fighting & Gas distribution

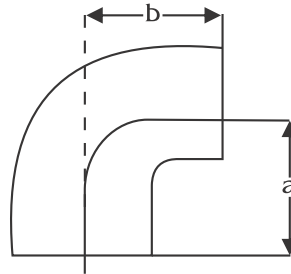

SIZE	3/4x1/2"	1x1/2"	1x3/4"	1 1/4x1/2"	1 1/4x3/4"	1 1/2x1"	1 1/2x1/2"	1 1/2x3/4"	1 1/2x1"	1 1/2x1 1/4"	2x1/2"	2x3/4"	2x1"	2x1 1/4"
A	30.00	32.00	35.00	34.00	36.00	40.00	36.00	39.00	42.00	46.00	38.00	41.00	44.00	48.00
B	31.00	34.00	36.00	39.00	41.00	42.00	42.00	44.00	46.00	48.00	48.00	50.00	51.00	53.00

SIZE	2x1 1/2"	2 1/2x1/2"	2 1/2x3/4"	2 1/2x1"	2 1/2x1 1/4"	2 1/2x1 1/2"	2 1/2x2"	3x2"	3x2 1/2"	4x2"	4x3"				
A	52.00	41.00	44.00	47.00	52.00	55.00	61.00	64.00	72.00	70.00	84.00				
B	55.00	57.00	59.00	60.00	62.00	63.00	66.00	73.00	76.00	86.00	92.00				

ELBOW MALE FEMALE

92

Available in BSP / BSPT & NPT Threads
Leakage, Corrosion and rust resistant
Ideal option for high pressure applications
High durability & Superior finish
High tensile strength

Applications: Irrigation, Water supply, Plumbing,
Water wells and Cold Storage applications, Fire Fighting & Gas distribution

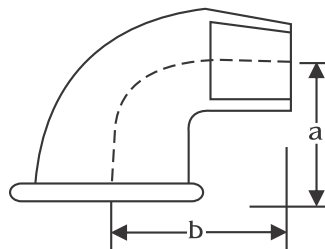

SIZE	1/2"	3/4"	1"	1 1/4"	1 1/2"	2"	2 1/2"	3"	4"						
A	28.00	33.00	38.00	45.00	50.00	58.00	69.00	78.00	96.00						
B	37.00	43.00	52.00	60.00	65.00	74.00	88.00	98.00	118.00						



TEE REDUCING (HBRT)

1130R

Available in BSP / BSPT & NPT Threads
 Leakage, Corrosion and rust resistant
 Ideal option for high pressure applications
 High durability & Superior finish
 High tensile strength

Applications: Irrigation, Water supply, Plumbing,
 Water wells and Cold Storage applications, Fire Fighting & Gas distribution

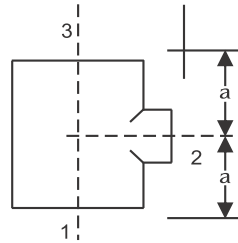

SIZE	3/4x1/2"	1x1/2"	1x3/4"	1 1/4x1/2"	1 1/4x3/4"	1 1/4x1"	1 1/2x1/2"	1 1/2x3/4"	1 1/2x1"	1 1/2x1 1/4"	2x1/2"	2x3/4"	2x1"	2x1 1/4"
A	30.00	32.00	35.00	34.00	36.00	40.00	36.00	39.00	42.00	46.00	38.00	41.00	44.00	48.00
B	31.00	34.00	36.00	39.00	41.00	42.00	42.00	44.00	46.00	48.00	48.00	50.00	51.00	53.00

SIZE	2x1 1/2"	2 1/2x1/2"	2 1/2x3/4"	2 1/2x1"	2 1/2x1 1/4"	2 1/2x1 1/2"	2 1/2x2"	3x2"	3x2 1/2"	4x2"	4x3"			
A	52.00	41.00	44.00	47.00	52.00	55.00	61.00	64.00	72.00	70.00	84.00			
B	55.00	57.00	59.00	60.00	62.00	63.00	66.00	73.00	76.00	86.00	92.00			

SIDE OUTLET TEE (FOUR WAY)

1223

Available in BSP / BSPT & NPT Threads
 Leakage, Corrosion and rust resistant
 Ideal option for high pressure applications
 High durability & Superior finish
 High tensile strength

Applications: Irrigation, Water supply, Plumbing,
 Water wells and Cold Storage applications, Fire Fighting & Gas distribution

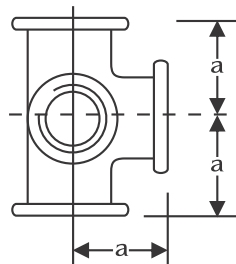

SIZE	1/2"	3/4"	1"	1 1/4"	1 1/2"	2"								
A	28.00	33.00	38.00	45.00	50.00	58.00								

CROSS

180

Available in BSP / BSPT & NPT Threads
 Leakage, Corrosion and rust resistant
 Ideal option for high pressure applications
 High durability & Superior finish
 High tensile strength

Applications: Irrigation, Water supply, Plumbing,
 Water wells and Cold Storage applications, Fire Fighting & Gas distribution

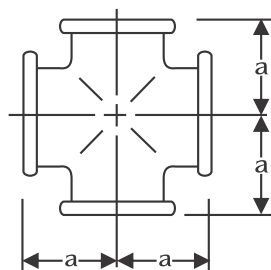

SIZE	1/2"	3/4"	1"	1 1/4"	1 1/2"	2"	2 1/2"	3"	4"	5"	6"			
A	28.00	33.00	38.00	45.00	50.00	58.00	69.00	78.00	96.00	115.00	131.00			



SIDE OUTLET ELBOW

1221

Available in BSP / BSPT & NPT Threads
Leakage, Corrosion and rust resistant
Ideal option for high pressure applications
High durability & Superior finish
High tensile strength

Applications: Irrigation, Water supply, Plumbing,
Water wells and Cold Storage applications, Fire Fighting & Gas distribution

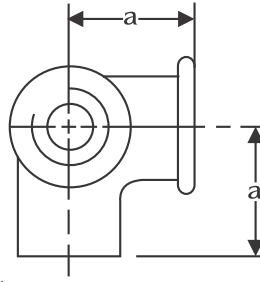

SIZE	1/2"	3/4"	1"	1¼"	1½"	2"								
A	28.00	33.00	38.00	45.00	50.00	58.00								

TEE BANDED EQUAL (BT)

130

Available in BSP / BSPT & NPT Threads
Leakage, Corrosion and rust resistant
Ideal option for high pressure applications
High durability & Superior finish
High tensile strength

Applications: Irrigation, Water supply, Plumbing,
Water wells and Cold Storage applications, Fire Fighting & Gas distribution

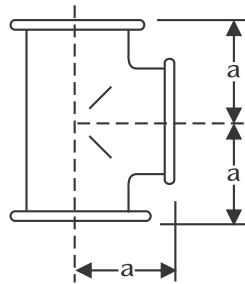

SIZE	1/2"	3/4"	1"	1¼"	1½"	2"	2½"	3"	4"	5"	6"				
A	28.00	33.00	38.00	45.00	50.00	58.00	69.00	78.00	96.00	115.00	131.00				

TEE EQUAL (HBT)

1130

Available in BSP / BSPT & NPT Threads
Leakage, Corrosion and rust resistant
Ideal option for high pressure applications
High durability & Superior finish
High tensile strength

Applications: Irrigation, Water supply, Plumbing,
Water wells and Cold Storage applications, Fire Fighting & Gas distribution

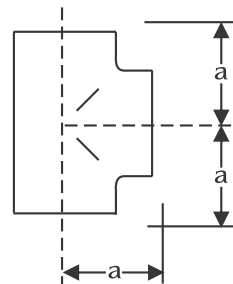

SIZE	1/2"	3/4"	1"	1¼"	1½"	2"	2½"	3"	4"	5"	6"				
A	28.00	33.00	38.00	45.00	50.00	58.00	69.00	78.00	96.00	115.00	131.00				



COUPLINGS (HBS)

220

Available in BSP / BSPT & NPT Threads
 Leakage, Corrosion and rust resistant
 Ideal option for high pressure applications
 High durability & Superior finish
 High tensile strength

Applications: Irrigation, Water supply, Plumbing,
 Water wells and Cold Storage applications, Fire Fighting & Gas distribution

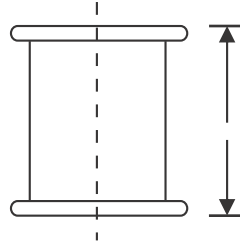

SIZE	1/2"	3/4"	1"	1¼"	1½"	2"	2½"	3"	4"	5"	6"				
A	36.00	39.00	45.00	50.00	55.00	65.00	71.00	78.00	94.00	109.00	120.00				

SOCKET COUPLINGS PLAIN (S)

1220

Available in BSP / BSPT & NPT Threads
 Leakage, Corrosion and rust resistant
 Ideal option for high pressure applications
 High durability & Superior finish
 High tensile strength

Applications: Irrigation, Water supply, Plumbing,
 Water wells and Cold Storage applications, Fire Fighting & Gas distribution

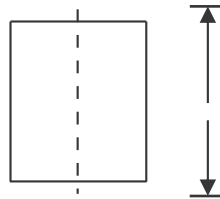

SIZE	1/2"	3/4"	1"	1¼"	1½"	2"	2½"	3"	4"	5"	6"				
A	36.00	39.00	45.00	50.00	55.00	65.00	71.00	78.00	94.00	109.00	120.00				

REDUCING SOCKET BANDED (BRS)

240

Available in BSP / BSPT & NPT Threads
 Leakage, Corrosion and rust resistant
 Ideal option for high pressure applications
 High durability & Superior finish
 High tensile strength

Applications: Irrigation, Water supply, Plumbing,
 Water wells and Cold Storage applications, Fire Fighting & Gas distribution

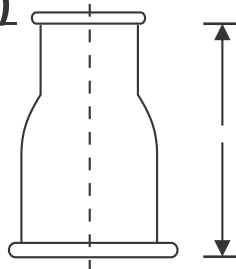

SIZE	3/4x1/2"	1x1/2"	1x3/4"	1¼x1/2"	1¼x3/4"	1¼x1"	1½x1/2"	1½x3/4"	1½x1"	1½x1¼"	2x1/2"	2x3/4"	2x1"	2x1¼"
A	39.00	45.00	45.00	50.00	50.00	50.00	55.00	55.00	55.00	55.00	65.00	65.00	65.00	65.00

SIZE	2x1½"	2½x1/2"	2½x3/4"	2½x1"	2½x1¼"	2½x1½"	2½x2"	3x1½"	3x2"	3x2½"	4x2"	4x2½"	4x3"	
A	65.00	71.00	71.00	74.00	74.00	74.00	74.00	80.00	80.00	80.00	94.00	94.00	94.00	



COUPLINGS REDUCING (HBRS)

1240

Available in BSP / BSPT & NPT Threads
 Leakage, Corrosion and rust resistant
 Ideal option for high pressure applications
 High durability & Superior finish
 High tensile strength

Applications: Irrigation, Water supply, Plumbing,
 Water wells and Cold Storage applications, Fire Fighting & Gas distribution

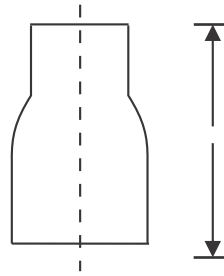

SIZE	3/4x1/2"	1x1/2"	1x3/4"	1 1/4x1/2"	1 1/4x3/4"	1 1/4x1"	1 1/2x1/2"	1 1/2x3/4"	1 1/2x1"	1 1/2x1 1/4"	2x1/2"	2x3/4"	2x1"	2x1 1/4"
A	39.00	45.00	45.00	50.00	50.00	50.00	55.00	55.00	55.00	55.00	65.00	65.00	65.00	65.00

SIZE	2x1 1/2"	2 1/2x1/2"	2 1/2x3/4"	2 1/2x1"	2 1/2x1 1/4"	2 1/2x1 1/2"	2 1/2x2"	3x1 1/2"	3x2"	3x2 1/2"	4x2"	4x2 1/2"	4x3"	
A	65.00	71.00	71.00	74.00	74.00	74.00	74.00	80.00	80.00	80.00	94.00	94.00	94.00	

UNION FLAT SEAT

330

Available in BSP / BSPT & NPT Threads
 Leakage, Corrosion and rust resistant
 Ideal option for high pressure applications
 High durability & Superior finish
 High tensile strength

Applications: Irrigation, Water supply, Plumbing,
 Water wells and Cold Storage applications, Fire Fighting & Gas distribution

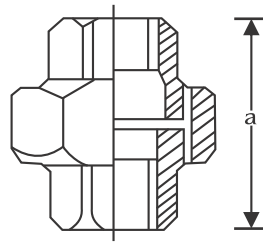

SIZE	1/2"	3/4"	1"	1 1/4"	1 1/2"	2"	2 1/2"	3"	4"	5"	6"				
A	48.00	52.00	58.00	65.00	70.00	78.00	85.00	95.00	110.00	135.00	150.00				

BUSHINGS (HBU)

241

Available in BSP / BSPT & NPT Threads
 Leakage, Corrosion and rust resistant
 Ideal option for high pressure applications
 High durability & Superior finish
 High tensile strength

Applications: Irrigation, Water supply, Plumbing,
 Water wells and Cold Storage applications, Fire Fighting & Gas distribution

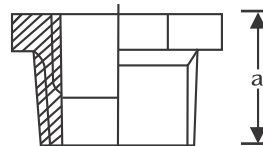

SIZE	3/4x1/2"	1x1/2"	1x3/4"	1 1/4x3/4"	1 1/4x1"	1 1/2x1 1/4"	2x1"	2x1 1/4"	2 1/2x3/4"	2 1/2x1"	2 1/2x1 1/4"	2 1/2x1 1/2"	2 1/2x2"	3x1 1/4"
A	26.00	29.00	29.00	31.00	31.00	31.00	35.00	35.00	40.00	40.00	40.00	40.00	40.00	44.00

SIZE	4x3/4"	4x1"	4x1 1/2"	4x2"	4x3"									
A	51.00	51.00	51.00	51.00	51.00									

HEX NIPPLE

280

Available in BSP / BSPT & NPT Threads
 Leakage, Corrosion and rust resistant
 Ideal option for high pressure applications
 High durability & Superior finish
 High tensile strength

Applications: Irrigation, Water supply, Plumbing,
 Water wells and Cold Storage applications, Fire Fighting & Gas distribution

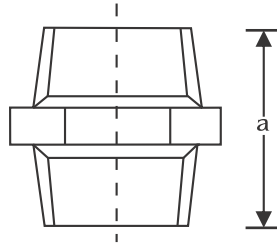

SIZE	1/2"	3/4"	1"	1¼"	1½"	2"	2½"	3"	4"						
A	44.00	47.00	53.00	57.00	59.00	68.00	75.00	83.00	95.00						

PLAIN PLUG

291

Available in BSP / BSPT & NPT Threads
 Leakage, Corrosion and rust resistant
 Ideal option for high pressure applications
 High durability & Superior finish
 High tensile strength

Applications: Irrigation, Water supply, Plumbing,
 Water wells and Cold Storage applications, Fire Fighting & Gas distribution

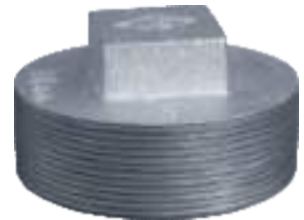
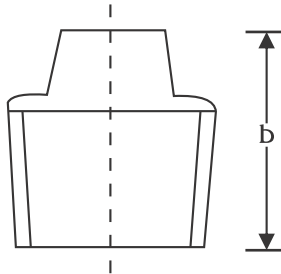

SIZE	1/2"	3/4"	1"	1¼"	1½"	2"	2½"	3"	4"						
B	18.00	20.00	23.00	29.00	30.00	36.00	39.00	44.00	58.00						

BEND BANDED 90° (BMBE)

1

Available in BSP / BSPT & NPT Threads
 Leakage, Corrosion and rust resistant
 Ideal option for high pressure applications
 High durability & Superior finish
 High tensile strength

Applications: Irrigation, Water supply, Plumbing,
 Water wells and Cold Storage applications, Fire Fighting & Gas distribution

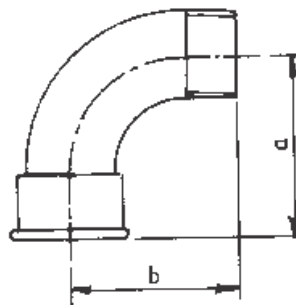

SIZE	1/2"	3/4"	1"	1¼"	1½"	2"	2½"	3"	4"						
A	45.00	50.00	63.00	76.00	85.00	102.00	--	--	--						



FLOOR FLANGE (FF)

321

Available in BSP / BSPT & NPT Threads
Leakage, Corrosion and rust resistant
Ideal option for high pressure applications
High durability & Superior finish
High tensile strength

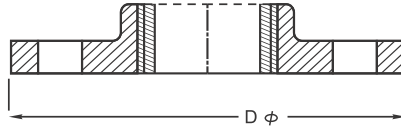

Applications: Irrigation, Water supply, Plumbing,
Water wells and Cold Storage applications, Fire Fighting & Gas distribution

SIZE	1/2"	3/4"	1"	1¼"	1½"	2"	2½"	3"	4"	5"	6"				
D	80.00	90.00	100.00	120.00	130.00	140.00	160.00	180.00	210.00	240.00	265.00				

UNION ELBOW, GASKET TYPE

97

Available in BSP / BSPT & NPT Threads
Leakage, Corrosion and rust resistant
Ideal option for high pressure applications
High durability & Superior finish
High tensile strength

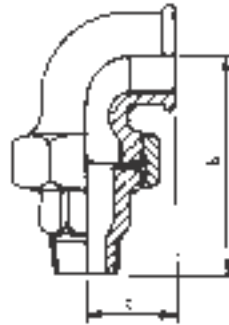

Applications: Irrigation, Water supply, Plumbing,
Water wells and Cold Storage applications, Fire Fighting & Gas distribution

SIZE	1/2"	3/4"	1"	1¼"											
B	76.00	82.00	94.00	107.00											
C	28.00	33.00	38.00	45.00											

BACKNUT (CHECK NUT)

310

Available in BSP / BSPT & NPT Threads
Leakage, Corrosion and rust resistant
Ideal option for high pressure applications
High durability & Superior finish
High tensile strength

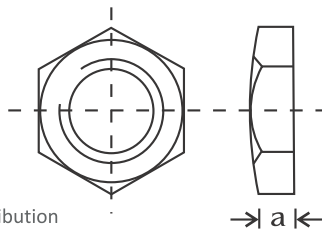

Applications: Irrigation, Water supply, Plumbing,
Water wells and Cold Storage applications, Fire Fighting & Gas distribution

SIZE	1/2"	3/4"	1"	1¼"	1½"	2"	2½"	3"							
A	8.00	9.00	10.00	11.00	12.00	13.00	16.00	19.00							

CAPS (HBCA)

301

Available in BSP / BSPT & NPT Threads
Leakage, Corrosion and rust resistant
Ideal option for high pressure applications
High durability & Superior finish
High tensile strength

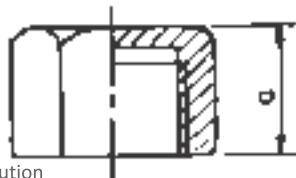

Applications: Irrigation, Water supply, Plumbing,
Water wells and Cold Storage applications, Fire Fighting & Gas distribution

SIZE	1/2"	3/4"	1"	1¼"	1½"	2"	2½"	3"							
A	19.00	22.00	24.00	27.00	27.00	32.00	35.00	38.00							



Forged Brass Valves
India's Famous Brand
Approved by Major Gas Companies

AN ISO 9001 : 2008
CERTIFIED CO.



 **Approved Valves**
 **Approved Valves**
EN331 Approved Valves



FEMALE BALL VALVE WITH UNION



JSI-07

JSI-07 Ball Valves with Union are manufactured in accordance with ISO 9001 and can be used for : domestic and commercial plumbing, industrial applications, agricultural requirements and heating, sanitary, pneumatic systems, waterworks, hot water services, condensate lines and is suitable for generally with every non-aggressive fluid.

Main Features :-

***M.O.P.** : 20 bar (300 psi), ***M.O.T.** : Working limit for fluids at - 20° C to 150° C, **Test pressure** : PN - 16, **Threading** : BSP, **Materials** : **BODY** : Brass, **Ball** : Brass, machined to a micro-smooth finish, Hard chrome plated, **Handle** : Dacromet rugged steel with PVC grip, **Ball Gaskets** : Conical rings in P.T.F.E. pure Teflon, **Vacuum** : 10 Torr., **Sizes** : 1/2", 3/4", 1".

FORGED BRASS GATE VALVE



JSI-08

JSI-08 Gate Valves are manufactured in accordance with BS 5154/B - PN 16 and can be used for : heating plants, sanitary systems, plumbing services, waterworks, pneumatic systems & steam.

Main Features :-

Body, Bonnet, Wedge : Forged brass, **Stem and Metal Components** : Machined from extruded brass, **Packing** : Suitable to a maximum temperature of 250° C,

Gland Packing : Asbestos free AF15 heat resistant fibre, elastomers, synthetic resin and PTFE, suitable to max. temp. of 250° C, **Handwheel** : Registered "JSI" model in hard duraluminium A1-SI 12 alloy showing "On-Off", BSP Female Threads, Integral seat in accordance in nominal dimension. **Hydrostatic Test Pressure** : Shell 25 Bar (350 psi), Seat 15 Bar (250 psi), **Sizes** : 1/2" to 6".

JOLLY CHECK VALVE

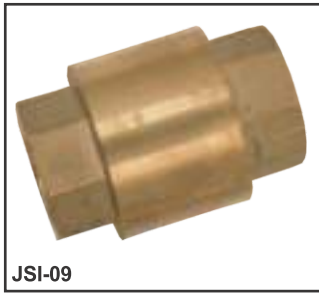

JSI-09

JSI-09 Jolly Check Valves can be used for : heating, sanitary, compressed air systems, pumps, autoclaves. It is suitable for installation either in vertical, horizontal or oblique pipelines to allow flow in one direction.

Main Features :-

The Jolly Check Valve opens & lifts under pressure of 0.25 bar (4psi) & is free to rotate. An arrow on the body indicates the direction of flow.

ADVANTAGES : Low pressure drop, prevents water hammer, compact design, noiseless in operation, no risk of fluid reverting the flow direction, full flow area equal to nominal size, safe & reliable in operation.

Body & End Connector : Hot forged brass, **Spring** : 18/8 AISI 302 stainless steel, **Inner Valve** : Hostaform, **Valve Face** : NBR rubber, **Threading** : Female parallel threads to ISO 7/1, **Hydrostatic Test Pressure** : Shell 10 bar (150 psi), Seat 10 bar (150 psi), **Sizes** : 1/2" to 2".

FORGED SWING CHECK VALVE



JSI-10

JSI-10 Forged Swing Check Valves can be used for heating, sanitary, compressed air systems, pumps, autoclaves, handling water, air, vacuum etc. Can be used for vertical, horizontal or oblique pipelines to allow flow in one direction.

Main Features :-

The forged swing check valve opens and lifts under pressure of 0.25 bar (4psi), very low pressure drop, prevents water hammer. Compact

design, noiseless operation, dent proof hostaform soft seating. Full flow area equal to nominal size.

Body : Forged Brass, **Spring** : Conical tempered spring in SS 316, **Inner Valve** : Hostaform, **Valve Face** : NBR rubber, **ENDS** : Screwed BSP Female x female ends, **Pressure** : Shell 20 Bar Hydro, Seat 15 Bar Hydro, **Temp** : -10°C to +80°C, **Sizes** : 1/2" to 2".

FORGED FOOT VALVE WITH S.S. SCREEN



JSI-11

JSI-11 Foot Valves with S.S. Screen can be used for ; pumping of liquids from underground tanks. It is suitable for installation in vertical pipelines to allow fluid in one direction.

Main Features :-

The Foot Valves inner valve opens and lifts under pressure of 0.25 bar (4 psi) and free to rotate and fitted with an S.S. Screen.

Body & End Connectors : Hot forged brass, **Spring** : 18/8 AISI 302

stainless steel, **Inner Valve** : Hostaform, **Valve Face** : NBR Rubber, **Threading** : Female parallel threads to ISO-7/1, **Pressure** : Shell 10 bar (150 psi), Seat 10 bar (150 psi), **Sizes** : 1/2" to 2".

FORGED BALL BIB COCK (DETACHABLE HOSE FIXED HOSE)

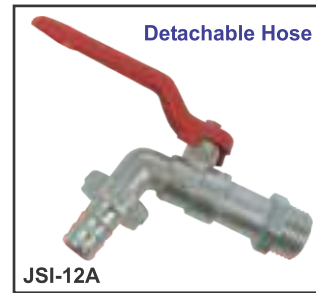

JSI-12A

Detachable Hose

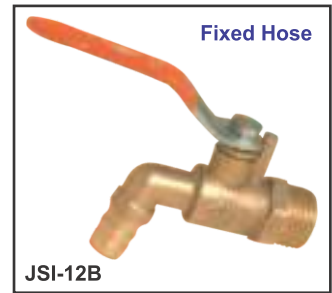

JSI-12B

Fixed Hose

JSI-12 Ball Bib Cock are manufactured in accordance with ISO 9001 and can be used for domestic plumbing, industrial applications, dispensing units and with all general applications where an attachment may be required to accommodate connection with external hoses.

Main Features :-

Heavy design enables exceptional wear resistance superior to traditional bib cock, completely leak proof. **Body** : Forged Brass, **Ball** : Forged brass, machined to mirror smooth finish, hard chrome plated, **Seat** : Pure PTFE conical arc cut, **Stem Seals** : PTFE, **Handle** : Duraluminium alloy, BSP male threads with knurling, ***M.O.P.** : 20 bar, ***M.O.T.** : Fluids -10°C to +100°C, **Sizes** : 1/2", 3/4".

* M.O.P. :- Maximum Operating Pressure, * M.O.T. :- Maximum Operating Temperature



FEMALE GAS BALL VALVE



JSI Fire Brass Ball Valves are approved in accordance to the latest Euro Norms EN: 331:1998. **Approved by UL/FM/ CSA.** Suitable for Water, Steam and Vacuum.

Can be used for Domestic and Commercial, Plumbing, Industrial Application, Sanitary, Pneumatic systems, Waterworks, Oil pipelines, Hot water services, Condensate services, Petrol & other hydrocarbon services and especially. **FIRE FIGHTING**

Main Features :-

Body : Forged Brass, **Ball** : Forged brass, machined to mirror smooth finish, Hard Chrome plated, **Seat** : Pure PTFE conical arc cut, **Stem Seal** : Double "O" Ring of Viton Rubber (Silicon Free), **Nut** : Self locking Nyloc nut.

FEMALE GAS BALL VALVE



JSI-03 Gas Ball Valves are approved in accordance to the latest Euro Norms EN : 331:1998. **Approved by Gujrat Gas.** Suitable for Water, Steam, Vacuum, Gas distribution such as Town Gas, Natural Gas, LPG etc. Can be used for Domestic and Commercial, Plumbing, Industrial Application, Agricultural requirements and heating, sanitary, pneumatic systems, waterworks, oil pipelines, hotwater services, condensate services, petrol and other hydrocarbon services etc.

Main Features :-

Body : Forged Brass, **Ball** : Forged brass, machined to mirror smooth finish, Hard Chrome plated, **Seat** : Pure PTFE conical arc cut, **Stem Seal** : Double "O" Ring of Viton Rubber (Silicon Free), **Nut** : Self locking Nyloc nut, BSP Female Threads. The sealing dimensions and ball diameter allow a blind operating angle $\geq 10^\circ$, **On Request** : American NPT threads ANSI B1.20.1, **Working Pressure** : Water 20 bar, Gas 10 bar, Vacuum 10^{-3} Torr. **Working Temperature** : Fluid at -20°C to $+150^\circ\text{C}$, **Gas** : -20°C to $+60^\circ\text{C}$, **Sizes** : $1/4"$ to $3"$.

FEMALE GAS BALL VALVE (WITH NOZZLE) FEMALE APPLIANCE VALVE

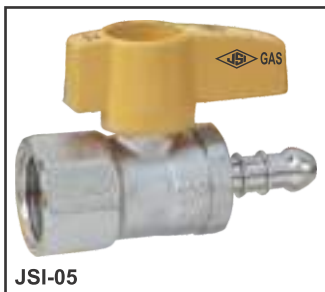

JSI-05 Female Gas Ball Valve with hose nipple is approved with European standard Gas applications (90/396/EEC) also in compliance to the latest Euro Norms EN:331:1998. Suitable for Water, Steam, Gas distribution such as Town Gas, Natural gas, LPG etc. Can be used for Domestic and Commercial, Plumbing, Industrial applications, sanitary, pneumatic systems, waterworks, oil pipelines, hot water services, condensate services, petrol and other hydrocarbon

services etc. The **Female thread** with knurling provides full grip of PTFE thread seal tape covering any gaps properly & does not allow it to slip.

Main Features :-

Body : Forged Brass, **Ball** : Forged brass, machined to mirror finish, Hard Chrome plated, **HOSE UNION, CAP & STEM** : Machined from Brass rod, **Seat** : Pure PTFE conical arc cut, **STEM SEALS** : Double "O" Ring in Perbunan NBR - DIN 3635/1. **NUT** : Self locking Nyloc nut, BSP **female threads** with knurling, **Working Pressure** : Water 20 bar, Gas 10 bar, Vacuum 10^{-3} Torr., **Working Temperature** : Fluid at -20°C to $+180^\circ\text{C}$, **Gas** : -20°C to $+60^\circ\text{C}$, **Sizes** : $1/4"$ to $1/2"$ BSPT/NPT.

FORGED FILTER BALL VALVE



JSI-02 Forged Filter Ball Valves are manufactured in accordance with ISO 9001 and can be used for ; water works, heating systems, Sanitary, pneumatic systems, Protecting and expanding installation for the filtration of fluid, collecting impurities, sand, rust, metal shaving, assuring total protection of the system.

Main Features:-

***M.O.P.** : 20 bars (300 psi), ***M.O.T.** : Fluid at -20°C to 150°C , **Test**

Pressure : PN - 16, **Threading** : Standard female parallel threads to ISO 7/1, **Material** : **Body** : Hot pressed brass, nickel plated, **Ball** : Brass, machined to a micro - smooth finish, hard chrome plated, **Handle** : Hard duraluminium alloy A1 - Si 12, **Gaskets** : Conical rings in P.T.F.E. pure Teflon, **Strainer** : Stainless steel 18/8 \varnothing perforations 0.65 mm, **Vacuum** : 10 Torr., **Sizes** : $1/2"$ to $2"$.

FEMALE GAS BALL VALVE (WITH BUTTERFLY HANDLE)



JSI-04 Gas Ball Valves are approved in accordance to the latest Euro Norms EN : 331:1998, **Approved by GAIL INDIA & IGL.** Suitable for Water, Steam, Vacuum, Gas distribution such as Town Gas, Natural Gas, LPG etc. Can be used for Domestic and Commercial, Plumbing, Industrial Application, Agricultural requirements and heating, sanitary, pneumatic systems, waterworks, oil pipelines, hot water services, and other hydrocarbon services etc.

Main Features :-

Body : Forged Brass, **Ball** : Forged brass, machined to mirror smooth finish, Hard Chrome plated, **Seat** : Pure PTFE conical arc cut, **Stem Seal** : Double "O" Ring of Viton Rubber (Silicon Free), **Nut** : Self locking Nyloc nut, BSP Female Threads. The sealing dimensions and ball diameter allow a blind operating angle $\geq 10^\circ$, **Handle** : Butterfly Handle, **On Request** : American NPT threads ANSI B1.20.1, **Working Pressure** : Water 20 bar, Gas 10 bar, Vacuum 10^{-3} Torr., **Working Temp.:** Fluid at -20°C to $+150^\circ\text{C}$, **Gas** : -20°C to $+60^\circ\text{C}$, **Sizes** : $1/2"$ to $1"$. **Approved by Indraprastha Gas Ltd., New Delhi.**

MALE GAS BALL VALVE (WITH NOZZLE) MALE APPLIANCE VALVE

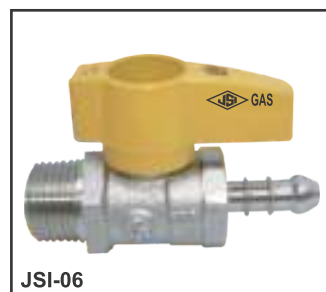

JSI-06 Male Gas Ball Valve with hose nipple is approved with European standard Gas applications (90/396/EEC) also in compliance to the latest Euro Norms EN:331:1998. Suitable for Water, Steam, Gas distribution such as Town Gas, Natural gas, LPG etc. Can be used for Domestic and Commercial, Plumbing, Industrial applications, sanitary, pneumatic systems, waterworks, oil pipelines, hot water services, condensate services. The

Male thread with knurling provides full grip of PTFE thread seal tape covering any gaps properly & does not allow it to slip.

Main Features :-

Body : Forged Brass, **Ball** : Forged brass, machined to mirror finish, Hard Chrome plated, **HOSE UNION, CAP & STEM** : Machined from Brass rod, **Seat** : Pure PTFE conical arc cut, **STEM SEALS** : Double "O" Ring in Perbunan NBR - DIN 3635/1. **NUT** : Self locking Nyloc nut, BSP **male threads** with knurling, **Working Pressure** : Water 20 bar, Gas 10 bar, Vacuum 10^{-3} Torr., **Working Temperature** : Fluid at -20°C to $+180^\circ\text{C}$, **Gas** : -20°C to $+60^\circ\text{C}$, **Sizes** : $1/4"$ to $1/2"$ BSPT.

* M.O.P. :- Maximum Operating Pressure, * M.O.T. :- Maximum Operating Temperature



BRASS FEMALE Y-TYPE STRAINER



JSI-14

JSI-14 Brass Female Y-Type Strainer is manufactured in accordance with ISO 9001 & can be used for commercial plumbing where clean water filtered out of 80/100 Micron filter is required, is used before water meter - Dental chair and to separate dust particles out of water for industrial purpose.

M.O.P : 20 bar (300 psi), **M.O.T** : Fluids at -20°C to 150°C

Sizes: 1/2" to 2" BSP.

AIR VENT VALVE



JSI-15

JSI-15 Air Vent Valve is manufactured in accordance with ISO 9001 & can be used for domestic & commercial plumbing, industrial applications, heating, sanitary, pneumatic systems, water works, hot water services, condensate services etc. where air pocket formation causes problems.

Main features :-

The Air Vent Valve allows the accumulated air in pipeline networks to breathe out of the systems thus

removing air pockets and eventually eliminating related problems such as noise, erratic water supply etc.

Body : Brass, **Max. Inlet Pressure** : 10 Bar, **Min. Working Pressure** : 0.1 Bar, **M.O.T** : 115°C.

A.C. BALL VALVE SET



JSI-16

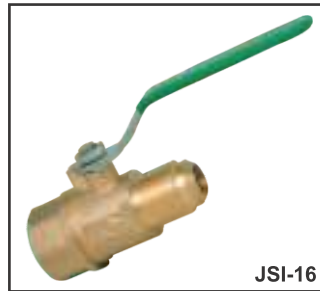

JSI-16

JSI-16 A.C. Ball Valve Set with strainer & without strainer are manufactured as per ISO 9001 & can be used in Industrial Air Conditioning.

Sizes : 3/4 x 5/8, 1" x 5/8".

PRESSURE REDUCING VALVE (S.S. PARTS)



JSI-17

JSI-17 Pressure Reducing Valve with SS Parts is suitable for controlling the outlet pressure of water in various applications such as before appliances, sanitary, domestic & Industrial plumbing requirements etc.

Main features :-

Metallic brass diaphragm system for better pressure control.

Max. Inlet : 15 Bars, **Outlet Range**: 0.5 - 6 Bars, Tested at 20 Bar.

Body : Forged brass, **Seal** : Stainless steel, "O" Ring : NBR **Ends** : Screwed BSP female ends. **Sizes** : 1/2" to 1".



NEE Components Pvt. Ltd.

(A member of NYLEX GROUP)

B-804, O2, Near Minerva Indl. Estate, Mulund (W), Mumbai - 400 080.
INDIA. | Tel. : 91-22-2593 1622/33/44 | Fax : 91-22-2593 1655
Email : nylexgroup@gmail.com | info@nylexgroup.com
Web : www.nylexgroup.com